



22 SEABORG 200J/JL /J-DH/JL-DH

Instruction Manual

Index

Caution-----1-7(1,2,3)

Power source-----8,9(1,2)

How to connect the power source 8
About the power source 9
Battery level indicator 9

Maintenance-----10,11

About maintenance 10
Maintenance procedure 10
Handling and maintenance of the power cord 11
Maintenance of the power cord 11
Other maintenance points 11

Names and functions of each part-----12,13

Names of the buttons and the display -----14

Introduction -----14

Functional setting-----15-47

1. How to operate the Menu screen -----15,16
Setting of useful functions 15,16
2. Main line input-----17-26
P1 Line Input 17-19
P2 Backing line input 20-23
P3 Line re-input 24-26
3. Sub counter-----27-29
Inverse counter 27
Winding speed 28
Time to wind up 29
4. Before start fishing-----30
Water surface zero setting 30
If the main line is broken 30
5. Auto stop-----31,32
Adjustable auto stop setting 31,32
6. Motor ON/OFF Interlocking Clutch -----33
7. Pickup/Pause -----34
8. Jigging-----35-37
9. Chumming Timer -----38
10. ChummingTimer winding-----39
11. Drag Sound -----40
12. Depth Alarm -----41
13. Water depth recalibration -----42
14. Actual fishing history -----43

15. Other useful functions -----44,45

Various alarms 44
Alarm sound ON/OFF setting 44
Language setting 45
Unit setting 45
Indication of manual winding speed 45
Counter lamp 45
Circuit breaker display 45

16. How to remove the handle knob-----46
(Single handle)

17. How to remove the handle knob-----47
(Double handle)

Reel Specifications-----48

Reel Specification list 48
Counter display 48

Parts List-----49,50

Trouble shooting-----51

List of options for line data input

This reel can be configured and set-up using the following options.

P1 Line Input 17-19

This option allows you to set useful functions when you know the length of the fishing line to be wound on the reel.

P2 Backing line input 20-23

This option allows you to set functions to insert a backing line. Note that it is necessary that you know the line length and that it is greater than 100 m.

P3 Line re-input 24-26

This option allows you to re-enter the line data, pulling out the line after it has been completely wound up onto the reel. Note that it is necessary that you know the line length and that it is greater than 60 m.

Thank you for purchasing a 22SEABORG 200J. Please read this operation manual carefully and use the product safely and correctly to take full advantage of this electric reel with many convenient features for your on-board fishing. Please keep this operation manual carefully together with your reel for your future reference.

Caution

This document contains important instructions for using your electric reel. Please be sure to read them thoroughly before use. Note that we will not warrant for any use of the product without reading the Instruction Manual and the "Warning List" supplied with the product before use.

About the signs



This sign means "prohibited actions." Within the area or near this sign, specific prohibited actions are described.



This sign means "actions that require caution." Within the area or near this sign, specific actions that require caution are described.



This sign means "mandatory actions." Within the area of this sign, specific mandatory actions are described.



WARNING

The following pertains to matters that could cause problems or serious, even life-threatening injuries should the instructions be ignored or incorrectly followed.

-Be careful not to catch your fingers between the reel and the level wind, which is used to wind line into the spool evenly. It may cause injury.



Hands off!

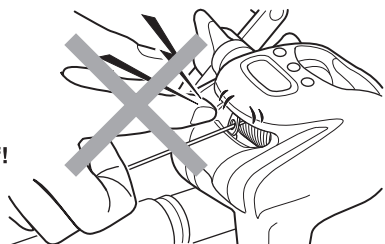

-When you turn on the clutch while feeding line (operated by the motor), it winds up the line. Be careful not to catch your fingers. It may cause injury.



Hands off!

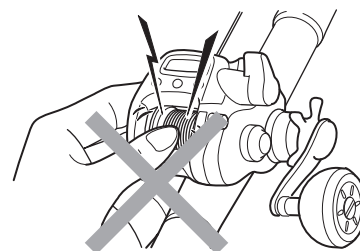

-Keep your eyes on your reel during use. Failure to do so may result in an unexpected accident or injury.

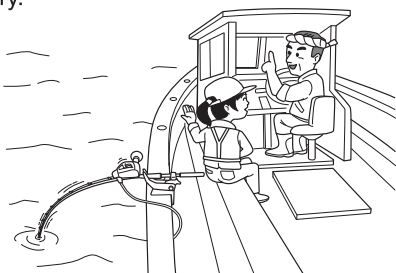

-For a big game fishing using large sized electric reel, make sure to fix the reel properly and firmly to the rod clamp or the holder. Failing to fix it firmly may result in an unexpected accident or injury.

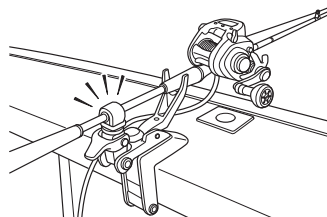

-Do not use the reel in an unbalanced and unnatural stance. Stand with your feet planted firmly on the ground to give you a balanced stance.

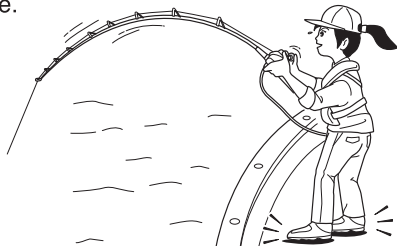

-Adults or parent's must supervise closely any use of this product by children. Use extreme caution to keep their fingers and hands away from moving parts or openings in the reel.



Cautious handling!

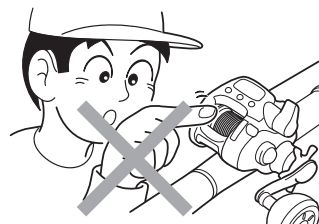

Caution

WARNING

The following pertains to matters that could cause problems or serious, even life-threatening injuries, should the instructions be ignored or incorrectly followed.

-Wear appropriate clothes and equipment during use. When you are not careful, you may be caught in the rotating parts or injured due to flying debris, resulting in serious injury or disability.

1. Keep your hair, clothing, and or gloves away from the rotating parts.
2. Wear non-slip footwear.
3. Cover long hair with a cap or hair cover.
4. Do not wear necklaces, neckties, or other jewelry and accessories that may be caught unexpectedly.
5. Be sure to wear equipment that protects your eyes, such as polarized glasses or eyeglasses.

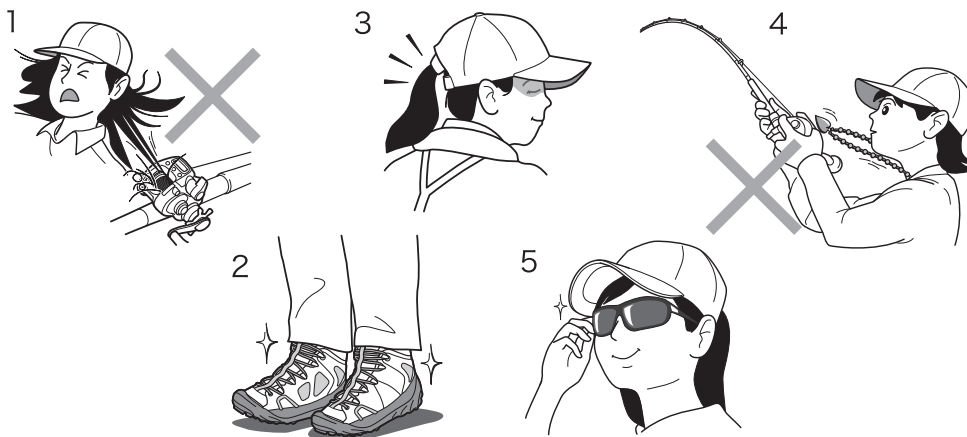

-Do not use and keep this product within the reach of children. Keep out of reach of children for storing or use of the product, as well as the reel itself, the packaged items and accessories.



Secure storage!

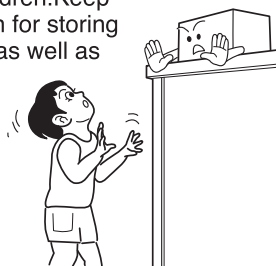

-When using batteries or the power supply of a boat, only apply the designated voltage. Other voltage may cause an abnormally high temperature in the electric reel, that could burn your hand or damage the microchip. Do not connect to house current or any AC (alternating current) power supply. The circuit may be short-circuited and result in smoke and fire.

-While using an electric reel, weak radio waves will be generated, which may affect medical equipment, such as malfunction of hearing aids and pacemakers. In particular for a person implanted with a heart pacemaker, use of electric reel may cause palpitations or dizziness; Do Not use this product.



Do not use!



Do not use!

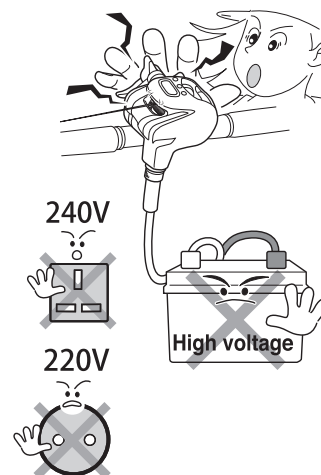

Caution

WARNING

The following pertains to matters that could cause problems or serious, even life-threatening injuries, should the instructions be ignored or incorrectly followed.

-Do not immerse the battery in a conductive material such as water. Doing so may cause the battery to be shorted out, resulting in damage, fire or getting burned.



-Do not fasten an electric reel with a harness onto your body. You may risk your life if pulled into the seawater by a big fish or in other situations.



Do not use!



-Keep the reel, cords, and batteries away from combustible materials and flammable substances (liquids, gases, and powder dust) to prevent ignition or explosion.

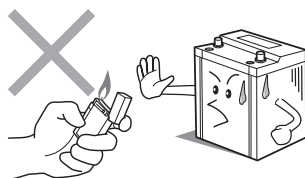

-Should the motor fail to stop for some reason while fishing, use caution to prevent your fingers being caught in the reel. Disconnect the power supply immediately.

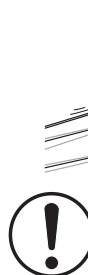

Remove power supply!

Remove!



-Ensure to fix the electric reel securely to the reel seat before use. Do not use the reel if it is seated unsteadily and rattled or if it cannot be fixed firmly. If the reel comes off during fishing, you may be injured.

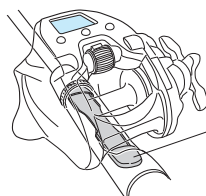

Reel seat

-Do Not connect the reel with the battery and or the cord when your hands are wet. Failure to do so may result in electric shock. If you connect it during rain, wipe your hands with a dry towel or the like and connect it quickly.

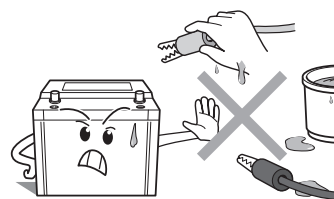

-Be careful not to get the power cord wrapped around your body. Failure to do so may result in getting dragged into the sea.



Cautious handling!

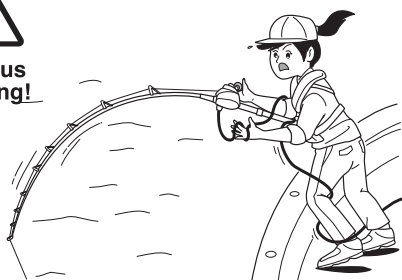

-Do not touch moving parts while in operation. It may cause injuries.



Hands off!

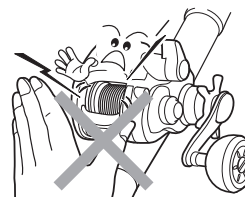

Caution

! WARNING

The following pertains to matters that could cause problems or serious, even life-threatening injuries, should the instructions be ignored or incorrectly followed.

-Follow the national and local regulations to dispose of the product and battery.

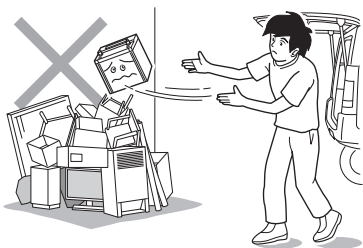

-Be sure to turn OFF the auto-wind lever before setting the dragging power. Failure to do so may result in your hand getting cut by the line while you are pulling it manually for setting the dragging power.



Stop winding

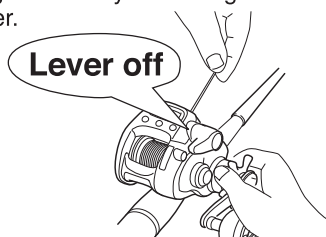

-Do not touch or grab the line when it is being released or wound rapidly. The line may cut your fingers.



Hands off!

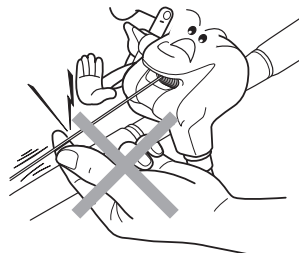

-When you do not use the product for fishing, turn off the winding lever and power supply. Failure to do so may result in unintended operation of the product, resulting in injury or other problems.

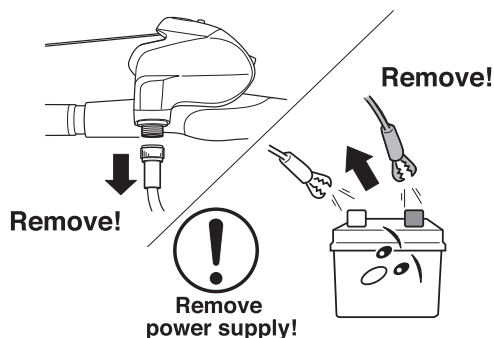

-Depending on the conditions of use or storage of the product, the cord may break or be shorted out, resulting in smoke or fire. Be sure to follow the "Precautions for Handling Cord", "Instructions for Maintenance of Cord" and "Other Precautions for Maintenance". Be sure to disconnect the power supply before maintenance of the cord. An old cord may cause breakage, short-circuit, or trouble. We recommend to replace the cord every two years or every 60 times of use, in order to maintain the performance of the reel.

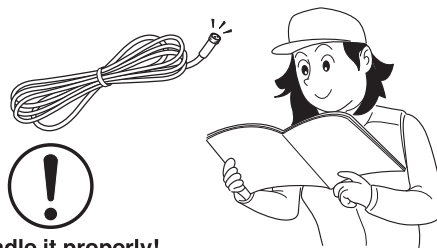

Handle it properly!

-Before reconnecting the power cable on the boat, thoroughly wipe away any moisture such as saltwater from the connecting parts with a dry cloth. If you connect it wet, it may short-circuit causing electric shock, smoke, or even fire.



Cautious handling!



-Do Not touch the heat radiation area of the motor. It may become hot, resulting in getting burned.



Hands off!

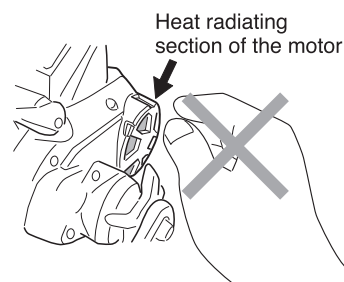

Caution

WARNING

The following pertains to matters that could cause problems or serious, even life-threatening injuries, should the instructions be ignored or incorrectly followed.

-Do Not attempt to disassemble or modify the reel. Failure to do so may cause problems with the performance of the reel or lead to malfunction. Also, this is not covered by the product warranty.



Do not modify!



-Do not modify the cable. It may cause a short-circuit or other problems and could result in smoke or fire.



Do not modify!



-Stop the operation before disconnecting the power supply. Failure to do so may result in malfunction. Shutting off the power while the reel is rotating may cause sparks, fire or explosion.

Remove!

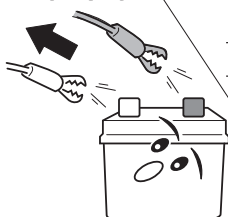

OFF!

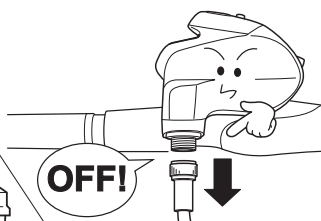

-Before going fishing, please check the reel for proper operation to ensure an enjoyable fishing trip.

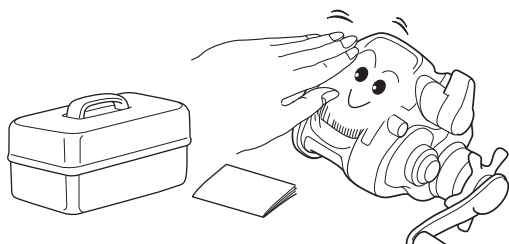

-In the event of abnormalities such as smelling burnt or leakage of electricity, immediately stop the operation and disconnect the power supply. Failure to do so may result in abnormal heat generation, fire, or electric shock.

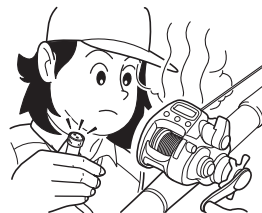

Remove power supply!

Remove!

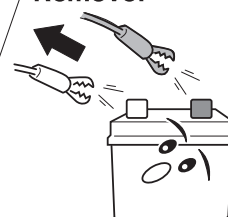

-Shocks, such as dropping the product, may cause breakage or damage to the internal electronic parts, cracks resulting in water intrusion, or short-circuit of the circuit board resulting in functional failure. Be careful not to apply strong shocks or heavy pressure to the product. (Even if there is no abnormality on its appearance, the product may be malfunctioned). Dropping the product also may cause you to be injured.



Cautious handling!

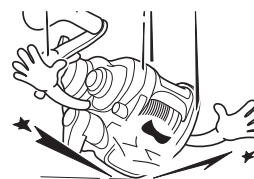

-Be careful not to get a piece of cloth, clothes, hair caught in the reel while winding up the line. Be careful not to wind the loosen line due to backlash, etc.

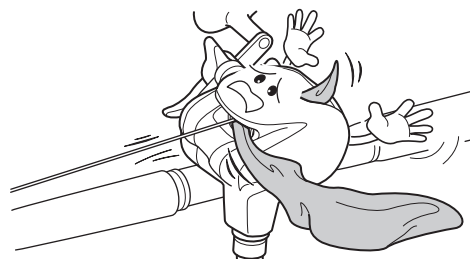

Caution

⚠ CAUTION

The following pertains to matters that could cause problems or serious, even life-threatening injuries, should the instructions be ignored or incorrectly followed.

-If the reel is dropped or shocked, the counter or the main body of the reel may crack resulting in water intrusion. Use of the reel in such a condition may cause the motor to be out of control, resulting in injury. Stop using the product and bring it to your nearest DAIWA dealer for repair.



Do not use!

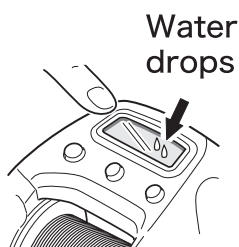

-When winding up line indoors, do so at high speed. If wound up at low speed and high tension, the motor may heat up abnormally and emit smoke. Power to wind up electronically may deteriorate.



Cautious handling!



-Do not wind up with excessive force when line is tangled with other angler's lines or snagged on the bottom. It may cause damage to your rod and other components.



Handle with care!

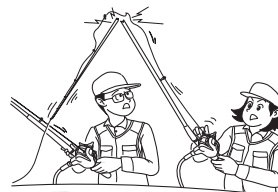

-Do not put a magnetic item such as magnet closer to the product. Otherwise, it malfunctions or causes failure.

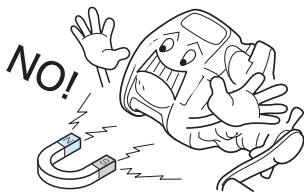

Cautious handling!



-Handle it cautiously as to not to stain your clothes with grease or oil from moving parts.



Risk of injury!



-When your hook is caught in the bottom, do not jerk the rod to free it. Pull the line with your hand and cut it if it fails to pull free. (Be sure to protect your hands with gloves or a towel.) If you use thick leader and cannot cut it with hands, talk to the captain for a safe treatment.

-Before connecting it to the power supply, be sure to loosen the drag well. If the IC breaks, and the motor does not stop, the terminal rig may be wound into the reel and the rod may break.



Required handling!

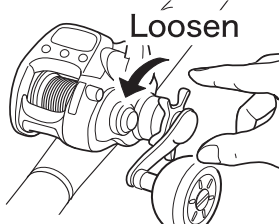

-Do not use wire line with your reel. It may cause corrosion or damage to the spool.



Do not use!

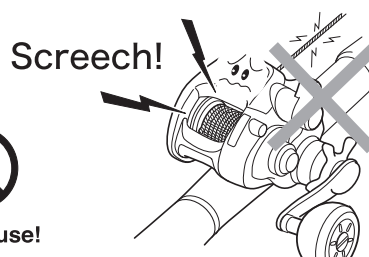

Caution

⚠ CAUTION

The following pertains to matters that could cause problems or serious, even life-threatening injuries, should the instructions be ignored or incorrectly followed.

-Use the reel only for the purpose of fishing.



Never use it for other purpose!

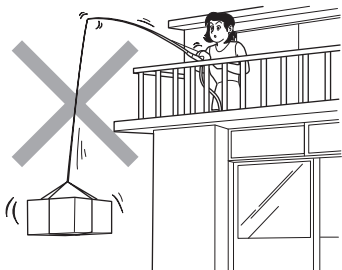

-Reset the counter whenever it displays the wrong number, you have cut off line, disconnected the power supply or changed Line thickness. If you use the reel without resetting the counter, your terminal rig may be pulled into the reel and break the rod or other components. Forgetting to reset it with your terminal rig at the water surface may cause the same problem.



Required operation!

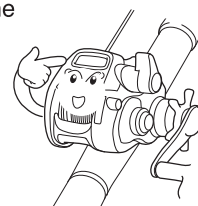

-Do not touch parts where the surface or top coatings (such as paint) are peeled off. It may cause injuries.



Hands off!



-Do not step on or place objects upon the reel. It may cause problems with the reel.

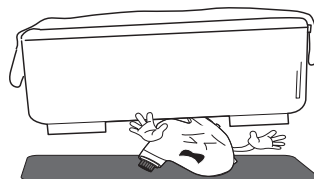

-Do not insert a stick or metallic object into the opening between the spool and the frame or other parts of the reel. It may cause problems with the reel.

NG!

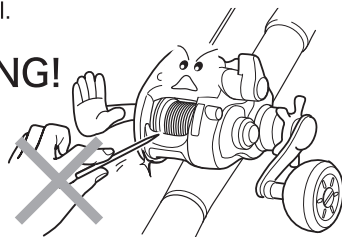

-Do not leave the reel near heating appliances. Resin may melt and deform or deteriorate causing problems.

Hoo

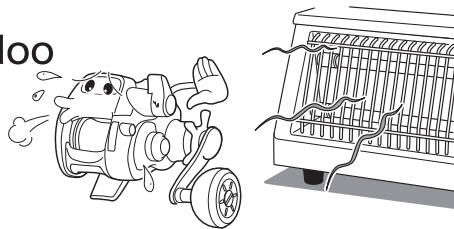

-Do not store a wet reel in a plastic bag or a fishing bag because it may cause rust or malfunction.

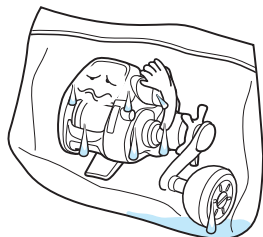

-When storing the reel for a long time, wipe down the moisture completely and preserve it in as well a ventilated place as possible without direct sunlight. Loosen the drag when storing it.

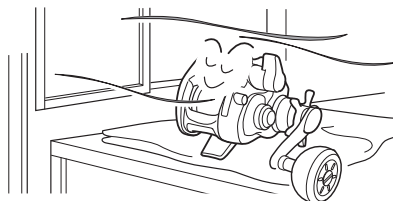

Caution

⚠ CAUTION

The following pertains to matters that could cause problems or serious, even life-threatening injuries, should the instructions be ignored or incorrectly followed.

-Use neutral detergent (dish washing detergent) when washing the electric reel. Do not use chlorine, acidic, or alcohol type cleaners. It may deteriorate resin and cause problems with the reel.

Neutral
detergent

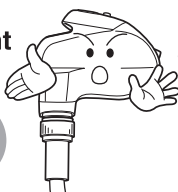

Chlorine, acidic,
alcohol



-Unplug the power supply and the cable when not in use.

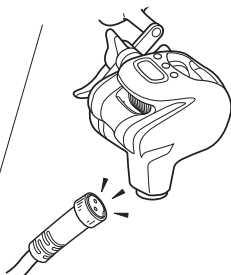

-The position of the pre-set auto-stop point varies depending on the tension of the line being wound. If you change the pre-set auto-stop point, reset the counter to zero at the water surface.

* Allow enough margin for setting the auto stop point. If you set it without enough margin, your fishing rod may be broken.



**Cautious
handling!**

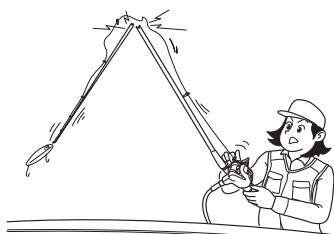

-When the reel is stored with the wet line with salt seawater, the spool may rust. Wash only the spool part with tap water to rinse off seawater sufficiently, and then dry it in a well ventilated place without direct sunlight before storing it.

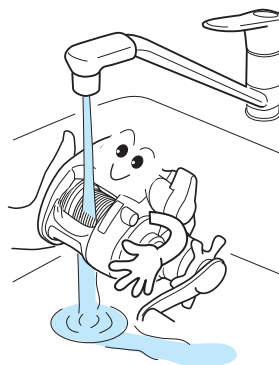

-Do not store the reel with tightly-wound, damp line. During storage, the line may dry up and shrink, resulting in damage to the spool. Do not wind nylon or fluorocarbon line onto a model designated exclusively for PE line (braided line).

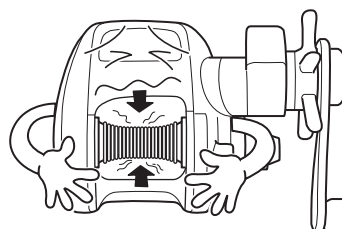

-If the breaker triggers repeatedly, the size of the reel does not match your fishing method or your target fish. Use a reel with the specifications and size that is best for your fishing.

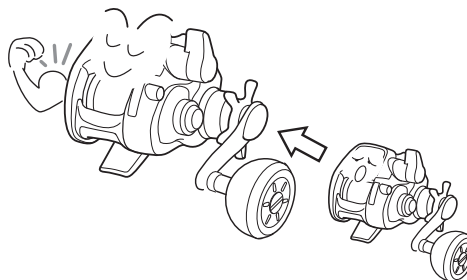

Caution

⚠ CAUTION

The following pertains to matters that could cause problems or serious, even life-threatening injuries, should the instructions be ignored or incorrectly followed.

-When shrinking a telescopic rod, do not tap rod butt on the ground with the reel attached. The reel may be damaged.

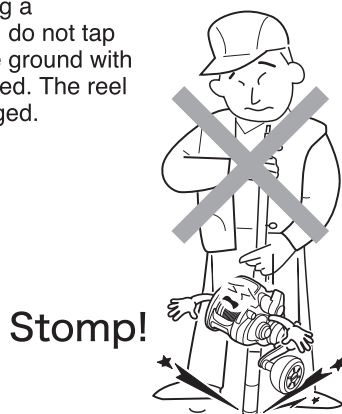

-When fixing the rod into a hole on the boat edge, verify that the reel does not touch the edge. When it touches, do not place it into the hole. The reel may be damaged.

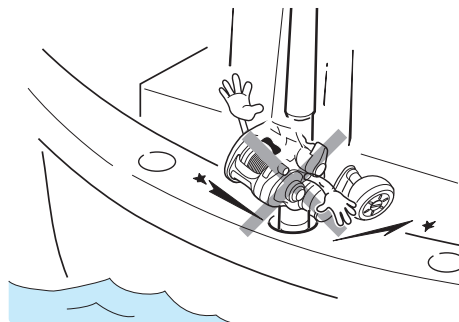

(MAGSEALED mounted model) INSTRUCTIONS FOR HANDLING

This document contains important instructions regarding special attention that may be required when using an electric reel. Please be sure to read them thoroughly before use.

■ MAG SEALED

MAG SEALED is a revolutionary mechanism designed to make a wall with magnetic fluid and keep water out. While maintaining smooth rotation, it sustains the initial rotation performance for a long time by keeping out water and foreign substances. The elimination of annoying salt adhesion can remove degraded rotation or noise created during long-term use, resulting in significantly improved durability.

■ MAG SEALED ball bearing

Our unique technology has turned the ball bearing itself to MAG SEALED. The wall of magnetic fluid prevents water or foreign substances from entering the inner ball bearing, which substantially eliminates noise and rust or salt adhesion on the ball bearing.

⚠ Attention

- Never lubricate the MAG SEALED ball bearing to avoid the loss of the MAG SEALED function.
- Never disassemble the ball bearing to avoid the loss of the MAG SEALED function.

⚠ Attention

- The excellent rustproof and dustproof performances of the MAG SEALED ball bearing are provided by the wall of magnetic fluid (MAG OIL) enclosed in the ball bearing.
- MAG OIL enclosed slightly greater in quantity could seep out of the ball bearing surface, but it will not affect performances.
(Do not wipe off the oil seeping out of the surface.)
 - Never touch or wipe the MAG SEALED ball bearing with your finger, cloth or a cotton bud.
Wiping off MAG OIL could impair the MAG SEALED function.

◆ About the counter display

1. Excessively cold or hot weather, mid-winter (display's surface temperature is below -10 degrees centigrade) and mid-summer (display's surface temperature is above 60 degrees centigrade).
*In the above cases, the characters may be difficult to see due to the characteristics of the liquid crystal. Please note.
2. When light strikes the display from certain angles, the display's digits may have shadows. This does not affect its function.

Registered trademark: This is a product for which DAIWA has obtained a registered trademark. Please be careful of counterfeit and similar products. The manufacture and sale of counterfeit products is punishable by the laws of each country.

Power source

How to connect the power source

1. Attach the cord clips to the battery.
Red covered clip is the plus (+), and the black covered clip is the minus (-).
2. Insert the connector into the reel. After this, the display appears as below.
By taking the appropriate steps, the indication will change as shown below and the data will be set.

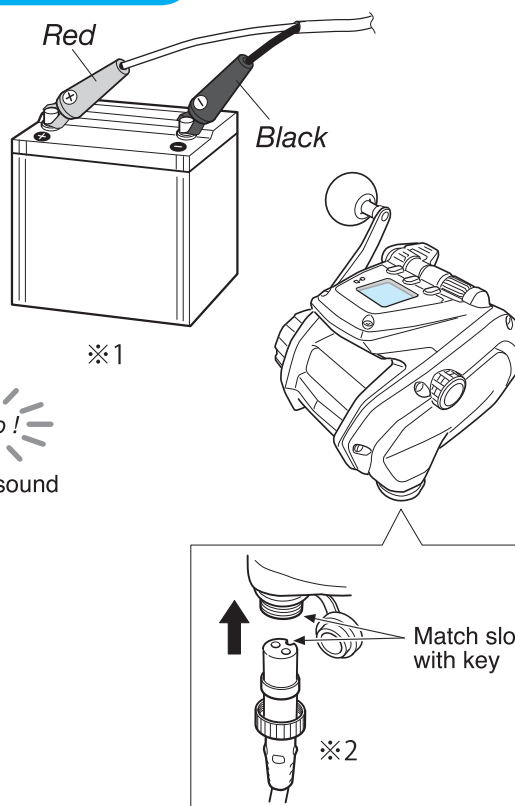

WARNING

* 1: Pay attention to the correct polarity. If the power cord is connected in reverse polarity (+/-), it will not conduct electricity and may also cause damage to the battery, the main unit, and the cord.

* Do not connect the power supply while your hands are wet with freshwater or seawater. Attempting to do so may result in electric shock. If you connect it during rain, wear rubber gloves before connecting it.

* 2: If it is connected incorrectly, it will not conduct electricity. Incorrect connection may cause short circuit, resulting in the power cord being broken. * Do not place combustibles or inflammables near the power supply, the reel, or this product. It may cause fire.

Attention

When changing batteries, the display's back up memory stays active for about 15 minutes after the old battery is disconnected. Thus the above display startup sequence does not need to replay when the new battery is connected within the 15 minute time frame.

Power source

About the power source

This reel is designed to be compatible with direct current DC 12 to 16.8 V. You may not use any power sources other than those specified to this reel (for example, AC100V from a household power supply and DC24V equipped on a boat).

The power source voltage on a boat tends to lose stability as it is largely influenced by a generator on board and wiring which may trigger the protective circuit causing sudden stop or intermittent operation of the reel. To maximize the reel performance, be sure to use the electric reel specific batteries.

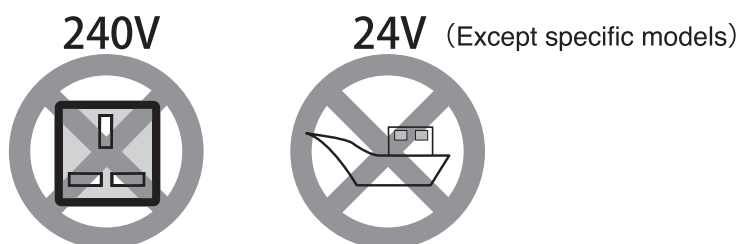

WARNING

1. We will not warrant any malfunctions or damages caused by the battery.
* Daiwa does not recommend to use any batteries of which product standards or safety standard Daiwa is not involved in and are labelled as compatible with Daiwa electric reels. Daiwa will not be liable for any accidents and damages caused by use of these batteries with Daiwa products. If you dare to use them, the use is at your own risk. Particularly, pay attention to the use of lithium batteries, which are likely to cause serious accidents.
2. Use of the power supply of your boat may cause damage to the supply system of the boat.
* If you use the power supply of the boat, do not use up all the power capacity while the engine is turned off.
* If the power supply is run out, the engine will not start and you will not be able to control your boat.
3. This reel is driven by DC 12V to 16.8V.
* Only the model "Marine Power 3000" is driven by 24V. Connecting it to a power supply with a voltage higher than 24 V or connecting to household power supply will damage the electronic circuit of the electric reel, resulting in the motor getting out of control. Incorrect connection may result in smoke or fire. Be sure to check the power supply environment and the specifications.

Attention

1. Do not use any power supply other than the specified ones.
As for the power source, we recommend the use of DEEPCYCLE battery which is waterproof secured for marine use.
Only the specified lithium power supply (in the country where it is sold) can be used for the reel.
* Please contact your nearest DAIWA dealer.
2. Connecting the unit directly to a household or marine power source may cause damage.
3. Recharge the battery before your fishing trip. Over time, a battery can naturally discharge.
4. Confirm the boat can provide the proper power source (i.e. voltage, connector shape etc).
-Corroded connections can prevent the flow of electric current. Remove any corrosion or dirt from the connectors.
5. Use a battery of the correct voltage output. Winding up with a high load while the voltage is low may damage electronic components.

Power source

Battery level indicator

When the battery voltage is lowered while powered ON, the battery level indicator becomes as shown below.

When the voltage goes down to 10V or less, the winding power of the reel is restricted and the maximum performance cannot be gained.

If this indicator is blinking while the motor is not running, battery voltage may be low due to decreasing of the residual capacity of the battery. If it is blinking, replace the battery with a recharged one (If you use the on-board power supply, check the voltage and the terminal of your boat).

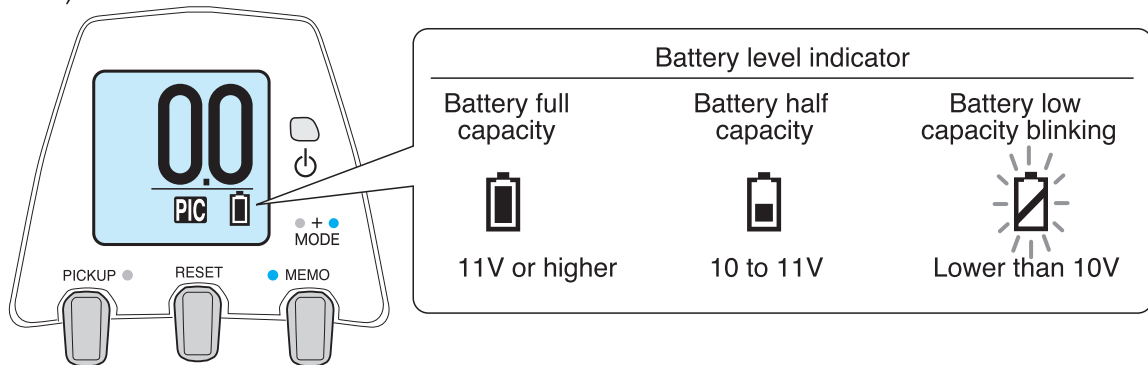

*There may be a slight difference between the reel detection voltage and the actual voltage of the power supply.

*When the battery runs out and the counter display goes out, be sure not to operate your electric reel manually to wind the line and be sure to replace the battery with a recharged one before doing any operations (relating to fishing). Any manual operation in such condition may cause the water depth counter to go out of order, resulting in the tip of fishing rod being broken due to accidentally winding up all the line when you restart an electrical winding later with a replaced battery.

Attention

-When a low battery indication appears, replace the battery with a fully charged one, as operation with low battery may cause problems with electric winding and or IC functions, etc.

Maintenance

About maintenance

This is a washable reel. Wash away salt residue and grit after fishing.

Maintenance procedure

1. Wash the reel with a dish washing detergent and a soft sponge. Do not use solvents.

*Do not use soap or other detergents. Other soaps or solutions may damage the reel both externally and internally.

*Recommended quantity: 1.5 ml per liter of water. The solution may damage the outside coating of the reel and may breakdown the grease inside of the reel creating an overflow of grease.

2. Rinse detergent and dirt away with running water, rinsing the spool very well to get rid of salt. Use warm water, under 30 degrees centigrade.

3. Dry the reel well.

*Loosen the drag when stored.

*Be sure to remove water from inside the handle knob, because water could stay there.

4. Feed oil.

Spray oil on the worm shaft.

*Recommended grease: Genuine reel guard grease

(product code: 2 380027)

Get the specific spray from a fishing-tackle store.

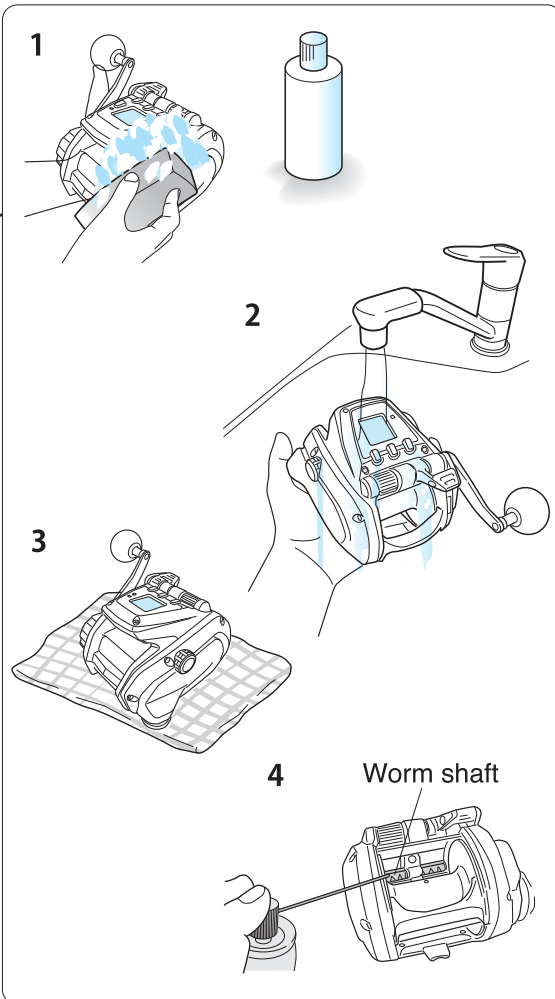

Attention

1. Do not wash with seawater or soak in water.
2. Do not use organic solvents such as benzene and thinner.
3. Do not use a steel brush or abrasive cleanser.
4. The fed oil may spring back and squirt. Do not peer down the worm shaft part.
5. Do not feed oil to water discharge hole.
6. Do not put magnetic force closer to the product main body.

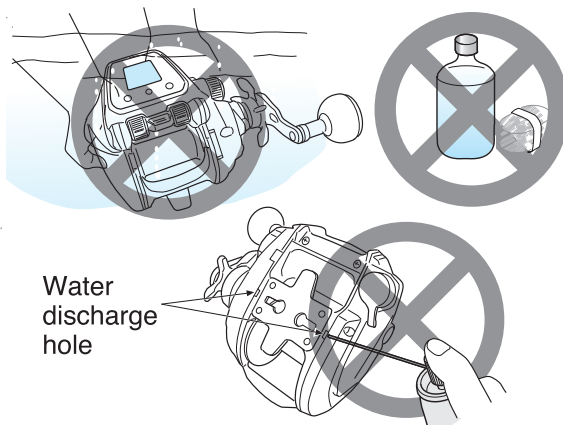

Maintenance

Handling and maintenance of the power cord

Follow the restrictions below to avoid troubles caused by disconnection of power cord and the like. Be sure to use the specific power cord supplied with the reel unit.

*Note that the unit is not compatible with any other power cord.

*Do not modify the power cord. It may cause an unintended failure. Be sure to keep the power cord intact.

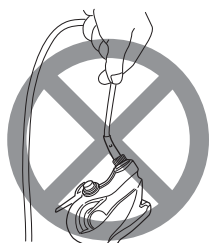

-Do not hang the reel by the power cord.

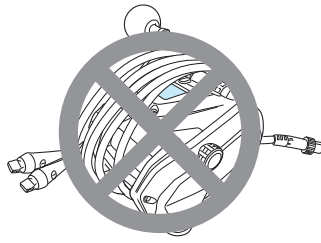

-Do not wind the power cord around the reel body with the connector inserted into the reel.

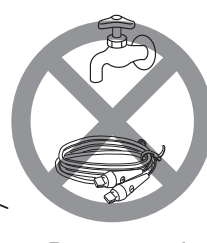
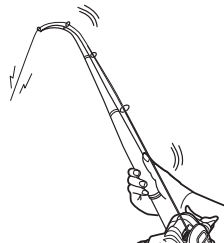

-Do not wash the power cord.

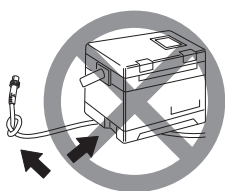

-Do not set heavy items on the power cord, or tie knots in the power cord.

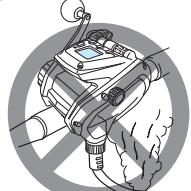

-If any abnormal events occur, including smoke and abnormal odor, stop the use of the power cord and remove it immediately from the battery.

-Note that the inner electric cable may be disconnected or broken despite of no visible damage on the appearance, if you step on the power cord, or if you pull the power cord strongly when it is trapped with cargoes, during use.

Maintenance of the power cord

-Wipe the power cord with a wet cloth and dry it well.

-Pay special attention to drying the tips, with cover removed.

-Grease the connector after it is dried.

*Recommended grease: SLPW connector grease 501 (Product code: 4 386502) The dedicated grease is available at fishing tackle shops.

-Disconnect the power cord from the reel before storing.

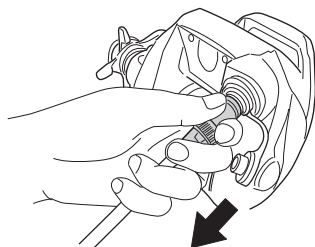

Hold the connector, not the power cord, to pull the power-cord from the reel.

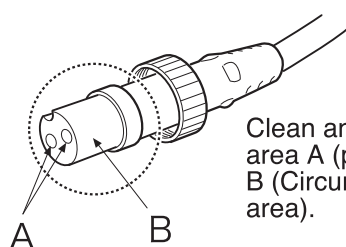

Clean and grease area A (pins) and area B (Circumferential area).

Other maintenance points

-This reel is a precision instrument that employs electric circuitry and motor. Do not disassemble the reel by yourself.

-Cover the power connector on the reel with its protection cap.

-An old cord may cause breakage, short-circuit, or trouble. We recommend to replace the cord every two years or every 60 times of use, in order to maintain the performance of the reel.

Names and functions of each part

※The figure shows 200J

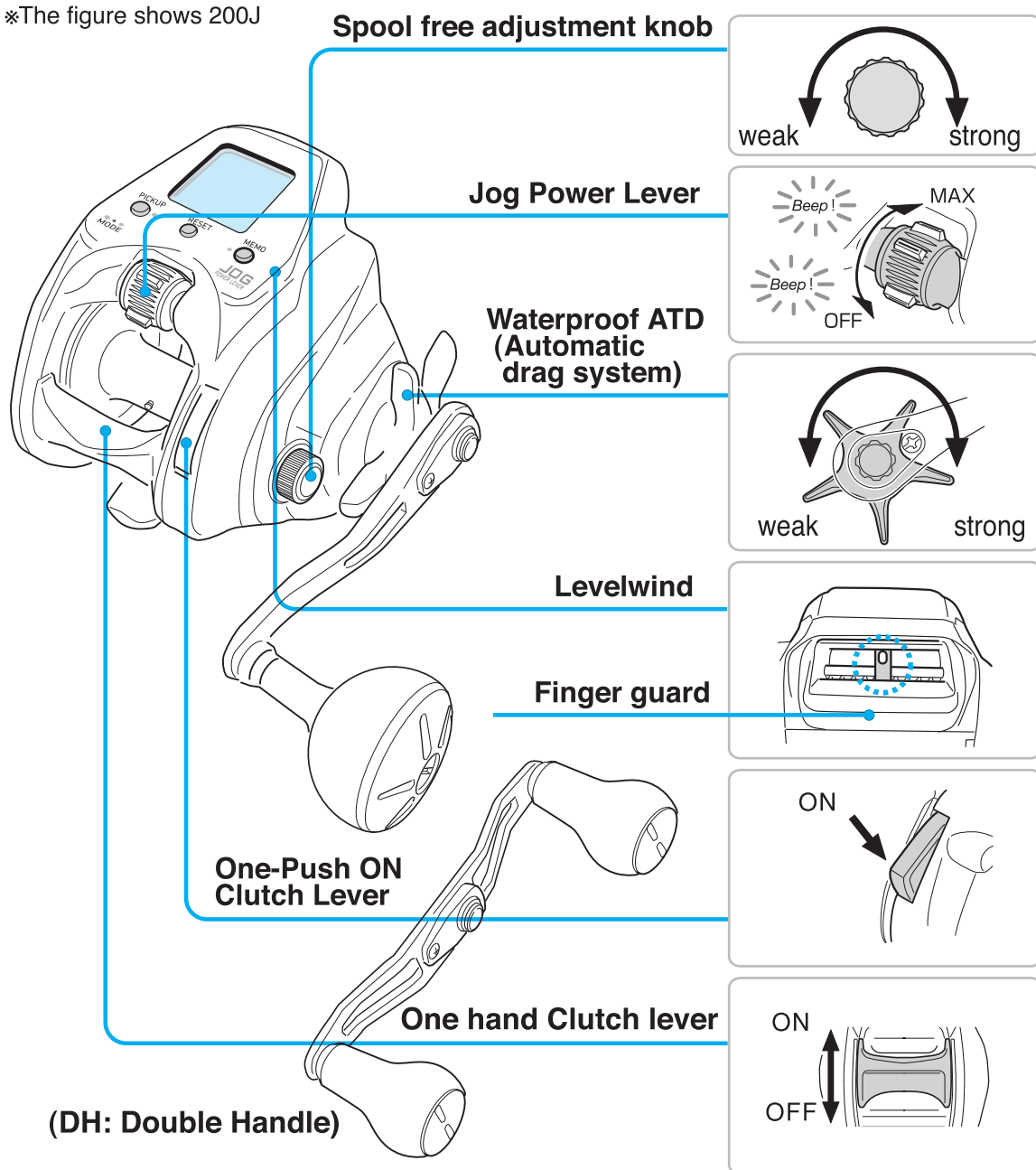

Accessories



Reel bag



Simple handling manual

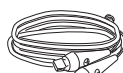

Air cord

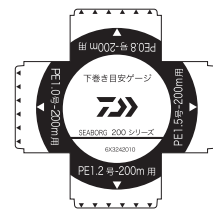

Backing line gauge



Access Guide



Warning List



Levelwind threader



Stand cover



Tools: (DH model only)

Names and functions of each part

Jog Power Lever

- Rotary lever can be rotated with your thumb.

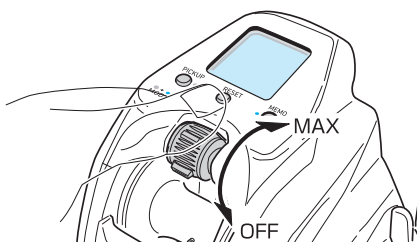

- You can freely adjust the winding power or the winding speed from OFF to MAX by using the lever.
- Turning the lever forward (toward MAX) will increase the winding power. Turning the lever back (toward OFF) will decrease the power.
- Check the position of the lever before you start winding. If it is not at OFF position, turn it back to OFF position (an audible alarm will sound to tell you that the lever has backed to the OFF position). Then, push the lever forward to start winding.
- Note that the lever does not accept your lever manipulation near the pre-set auto stop point for safety reasons.
- The displayed value for setting by the lever may fluctuate due to winding load fluctuation but it is not abnormal event.

Waterproof ATD (Automatic Drag System) *With a drag knob click system

- This is designed to provide a mechanism whereby adjusting the star drag allows the spool to slip against a strong pull to avoid line breakage.
- 1. Set the reel on the rod and put the line through the rod guide before adjusting the drag.
- 2. Adjust the tightness of the drag, with the clutch ON, manually pulling the line out from the reel. Normally, adjust the drag allowing the spool to slip before the line breakage (trace line).

One-Hand Clutch Lever

- You can disengage the clutch by slightly pressing down with your thumb.
- ◆While it is turned ON: Turn the handle to wind up the line.
- ◆While it is turned OFF: Spool is free. Turn the handle clockwise to turn ON the clutch.

One-Push ON Clutch Lever

- The clutch turns to ON by pressing the lever when the clutch is OFF.
- You can turn the clutch to ON quickly with your hand holding the rod.

Motor ON/OFF Interlocking Clutch

- The motor rotation stops when the clutch is

turned OFF during electric winding (while the motor is rotating). The electric winding (motor rotation) automatically restarts when the clutch is turned ON again.

- This captures signals of sensitive hits and strikes such as fish-bite and squid-touch while the jig is falling.

Spool free adjustment knob

- This is a brake system to prevent backlash (curls due to a slack of line). Adjust the strength of the brake depending on how much the boat is swaying, how heavy the rig is, etc.

Levelwind

- The levelwind allows to ensure an even winding of the line on the spool that is passed through the guide.
- *The line may be wound unevenly on the spool depending on the winding condition in some cases.

Accessories

- Air cord/Reel bag/Access Guide/Warning List/Simple handling manual/
- Tools: (DH model only)
- Backing line gauge
- Levelwind threader

It is used to put the line through the level wind.

- Stand cover
Use it to protect the reel and the rod and prevent rattling with respect to the reel seat.

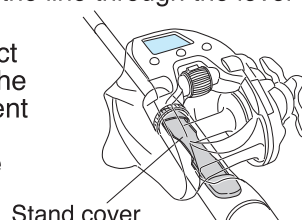

⚠ Attention

- * If the stand cover is attached, the reel will not be attached depending on the rod.
- * If the stand cover is attached to a type of rods with a rotary installation base, the stand cover may be broken.
- * Excessive tightening of the reel seat may cause the stand cover to be deformed and contact with the spool, resulting in decrease in the spool free performance (lowering of the terminal rig).

Names of the buttons and the display

※The figure shows 200J (in the case of 200JL, the buttons PICK UP and MEMO are reversely allocated).

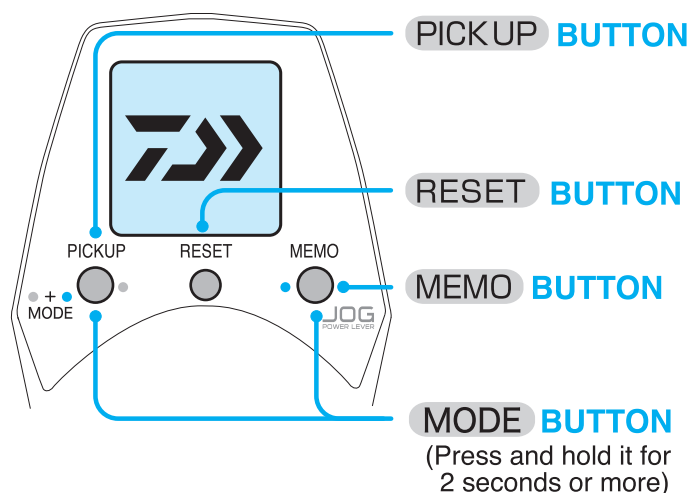

●RESET

- Press the **RESET BUTTON** once always before you start fishing. The auto stop position is set based on the point where you pressed the **RESET BUTTON**.
- Pressing and holding this button for 2 seconds or more allows you to correct the data when the line has broken.

●MEMO

- This button is used to reset the inverse counter or resume the chumming timer.
- Pressing and holding this button allows you to set the auto stop point.
- This button acts as **OK BUTTON** in the Menu screen.

●PICKUP

- The button is used to execute Pickup, Pause and Jigging.
- This button acts as a **(RETURN) BUTTON** in the Menu screen.

●MODE (Menu)

- Simultaneously pressing and holding both **MEMO BUTTON** and **PICKUP BUTTON** for 2 seconds or more will open the screen where you can set various convenient functions.

Introduction

Note that a 100 m or longer line of which length is known is necessary.

1. Turn ON your reel.

*As for connecting method, see P8 "How to connect the power source".

2. Select your desired language with the Jog Power Lever.

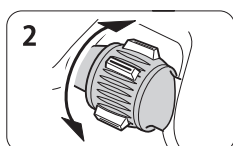

3. Confirm if the language selected is OK and press

200J **OK** (**MEMO BUTTON**)

200JL **OK** (**PICKUP BUTTON**).

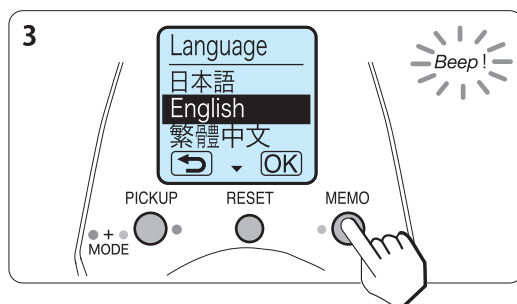

4. Select unit with the Jog Power Lever only when you select "English" and press
200J **OK** (**MEMO BUTTON**)
200JL **OK** (**PICKUP BUTTON**).

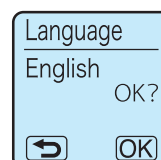

5. If the screen returns to the "Water Depth screen", then the setting is completed.

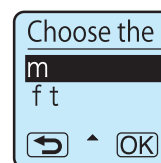

Attention:

The language and unit initially set can be changed afterward from the MENU screen.

-For details, please refer to the WEB manual "Language Selection"



Functional setting [1. How to operate the Menu screen]

Setting of useful functions

-The Menu provides various useful functions for your fishing.

*Once you have set up a parameter, it is saved in the memory for your next fishing.
(Settings may not be saved in the memory if you turn off the power immediately after setting)

1. When the display shows **0.0** press and hold both **MEMO BUTTON** and **PICKUP BUTTON** simultaneously for 2 seconds to show the Menu screen.

*The figure shows 200J
(in the case of 200JL, the buttons PICK UP and MEMO are reversely allocated).

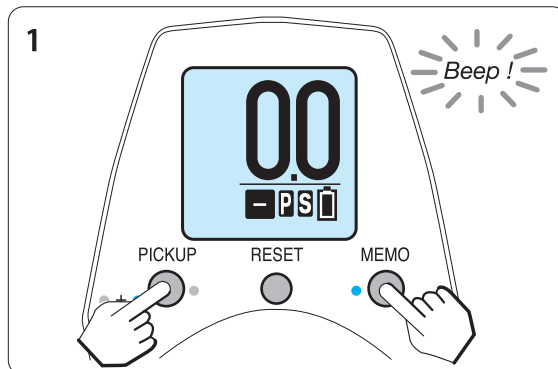

(Water Depth screen)

2. Select a parameter using the Jog Power Lever and press
200J **OK** (**MEMO BUTTON**)
200JL **OK** (**PICKUP BUTTON**)
to go the screen for setting.

*For details on setting of each parameter, please refer to the following pages.

MEMO BUTTON + PICKUP BUTTON (Press and hold)

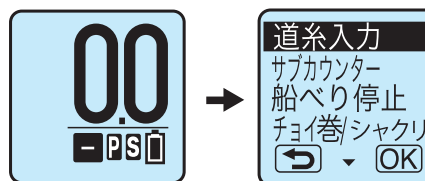

(Water Depth screen)

(Menu screen)

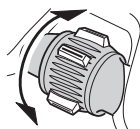

You can select your desired parameter using the Jog Power Lever.

道系入力	→ 『See P17-26』
サブカウンター	→ 『See P27-29』
船べり停止	→ 『See P31 and 32』
チョイ巻/シャクリ	→ 『See P33-37』
タイマー巻上	→ 『See P39』
アラーム音	→ 『See P44』
トラグ音	→ 『See P40』
テブスアラーム	→ 『See P41』
水深補正	→ 『See P42』
実釣来歴	→ 『See P43』
Language(言	→ 『See P44』
単位	→ 『See P45』

Functional setting [1. How to operate the Menu screen]

■ Operation in the Menu screen

Here, the Menu screen is used as an example to how to operate the screen.

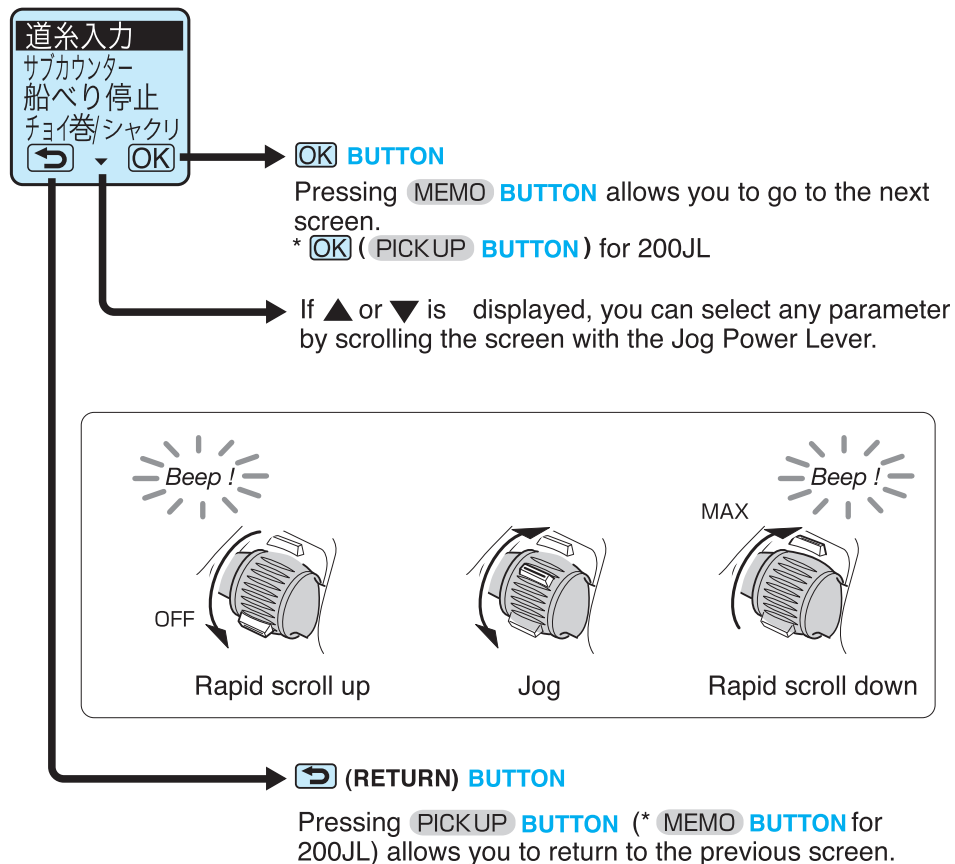

3. Once the settings have been completed, return to the Water Depth screen to start fishing.

Functional setting [2. Main line input]

P1 Line Input

This function is convenient when you know the length of the fishing line to be wound on the reel.
(The following example explains how to insert a PE 2-300m fishing line.)



Watch out for Burns!

An overly heated motor may cause the frame to become very hot, so do not touch it directly when inserting the main line. Insert the line while holding the frame with a wet towel, etc.

1. Pass the main line through the Level Wind and tie it to the spool.

- *The enclosed threading pin facilitates the process.
- *Make sure to tie the line to the line stopper to prevent the line from slipping on the spool.
- *Tighten the drag.

2. Return the Jog Power Lever to OFF.

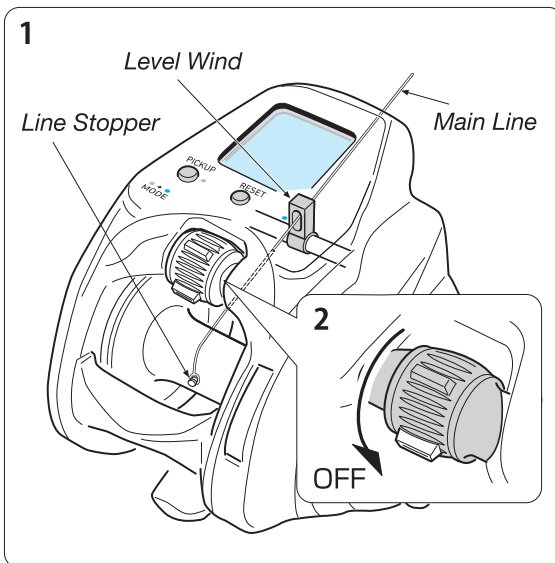

3. Turn on the reel.

- *Please refer to the page 8 “How to connect the power source” for the details of the connection method.

3



↓ (The screen when the reel is switched on)

4. When **0.0** is displayed, press and hold the switches **MEMO** **BUTTON** and **PICKUP** **BUTTON** simultaneously for 2 seconds.

- *The figure shows 200J
(in the case of 200JL, the buttons PICK UP and MEMO are reversely allocated).

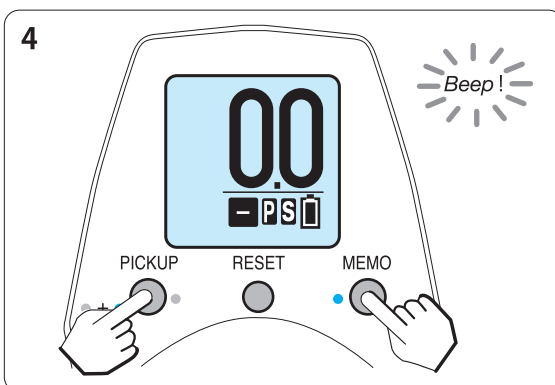

(Water Depth Screen)

Functional setting [2. Main line input]

P1 Line Input

5. Select "Line Input" with the Jog Power Lever and press

200J (MEMO **BUTTON**)

200JL (PICKUP **BUTTON**)

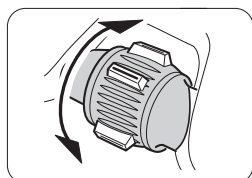

*By moving the Jog Power Lever, the selected item is highlighted on the screen.

*When the scrolling text «Do you wish to continue?» is displayed, press

200J (MEMO **BUTTON**)

200JL (PICKUP **BUTTON**)

one more time.

6. Select "Line Input P1" and then press

200J (MEMO **BUTTON**)

200JL (PICKUP **BUTTON**)

7. After adjusting the tension, turn the Jog Power Lever to the MAX position and then wind the main line.

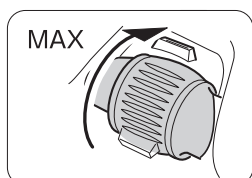

*While winding up the line, try to adjust the tension so that the mark ▼ stays around the screen center.

5

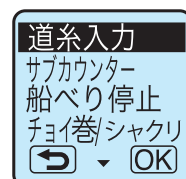

(Menu Screen)

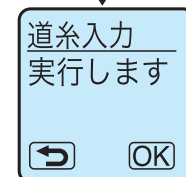

6

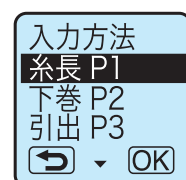

(Line Input Screen)

7

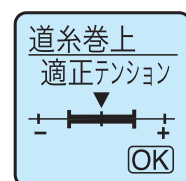

(Tension Meter Screen)

Attention

- The reel may be damaged if the line touches the finger-guard or the frame. Keep the line from touching these components.
- Winding the line indoors for a prolonged period at a low speed with an elevated tension may cause the motor to overheat and thus fail. Please input by turning the Jog Power Lever to the MAX position. While actual fishing in outdoors, there is no need to worry about overheat problem because motor is cooled down by seawater, etc.

Functional setting [2. Main line input]

P1 Line Input

8. When winding is complete, turn the Jog Power Lever back to the OFF position and then press
 200J **OK** (**MEMO** **BUTTON**)
 200JL **OK** (**PICKUP** **BUTTON**).

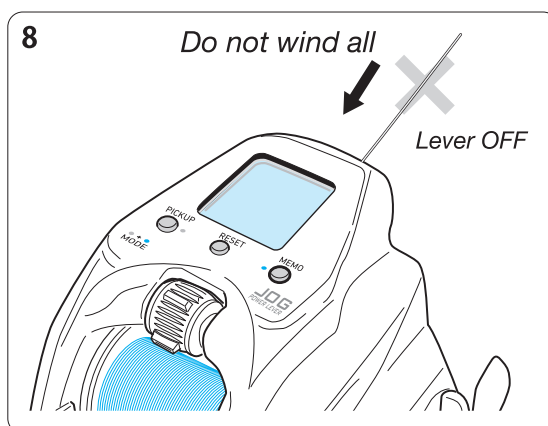
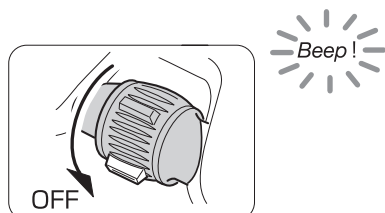

Attention

- Do not wind all the line. Before winding up all of the line, turn the Jog Power Level to the OFF position and then wind up the remaining line manually with the handle. Winding up all may cause an error with the counter.
- This winding method cannot be applied to lines thinner than PE 0.6.
- When winding a finer line below PE 2, the line may enter the gap between the spool and the frame it wound close to the spool's outer diameter; so, it is advisable to wind the line up to about 1mm inside the outer edge of the spool.

9. Select the line length with the Jog Power Lever and then press
 200J **OK** (**MEMO** **BUTTON**)
 200JL **OK** (**PICKUP** **BUTTON**).
- *The illustration shows a case of inserting 300m.
 *The default value is set at 300m.
 *The value can be set for every 10m.

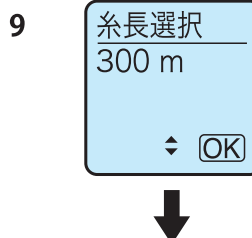
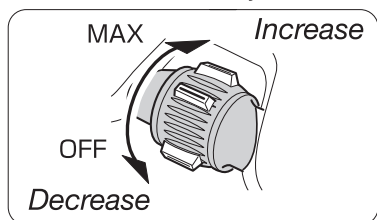

10. When "Complete" is displayed on the screen, press
 200J **OK** (**MEMO** **BUTTON**)
 200JL **OK** (**PICKUP** **BUTTON**)
 and the display will return to the water depth screen to complete inserting the line.

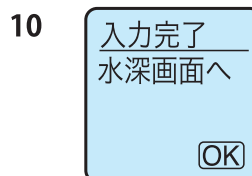

- *When "Error" is displayed while inserting the line, press
 200J **OK** (**MEMO** **BUTTON**)
 200JL **OK** (**PICKUP** **BUTTON**)
 to return to the water depth screen and re-start the process from the beginning.

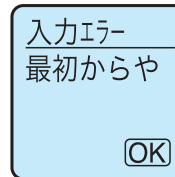

Functional setting [2. Main line input]

P2 Backing line input

Note that a 100 m or longer line of which length is known is necessary.



Watch out for Burns!

An overly heated motor may cause the frame to become very hot, so do not touch it directly when inserting the main line. Insert the line while holding the frame with a wet towel, etc.

1. Pass the main line through the Level Wind and tie it to the spool.

- *The enclosed threading pin facilitates the process.
- *Make sure to tie the line to the line stopper to prevent the line from slipping on the spool.
- *Tighten the drag.
- *If you have already completed winding of the backing line, skip this step and go to the next step.

2. Return the Jog Power Lever to OFF.

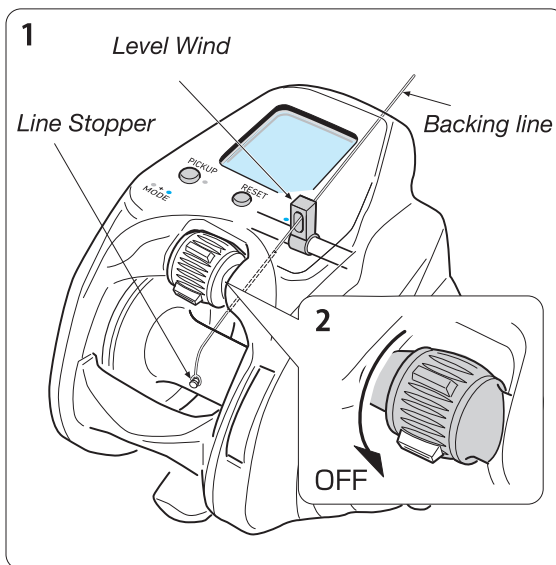

3. Turn on the reel.

- *Please refer to the page 8 “How to connect Power Supply” for the details of the connection method.

3



(The screen when the reel is switched on)

4. When **0.0** is displayed, press and hold the switches **MEMO** **BUTTON** and **PICKUP** **BUTTON** simultaneously for 2 seconds.

- *The figure shows 200J
(in the case of 200JL, the buttons PICK UP and MEMO are reversely allocated).

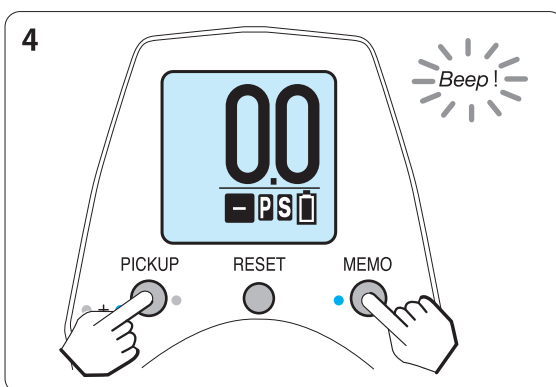

(Water Depth Screen)



Functional setting [2. Main line input]

5. Select "Line Input" with the Jog Power Lever and press
 200J (MEMO)
 200JL (PICKUP)

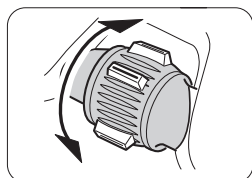

*By moving the Jog Power Lever, the selected item is highlighted on the screen.

*When the scrolling text 《Do you wish to continue?》 is displayed, press
 200J (MEMO)
 200JL (PICKUP) one more time.

6. Select "Backing line P2" and then press
 200J (MEMO)
 200JL (PICKUP)

*The screen automatically switches to "Speed Range"

7. Wind up the backing line. If winding of the backing line is completed, press
 200J (MEMO)
 200JL (PICKUP)

*Please adjust the winding volume of the backing line using the backing line gauge attached.

*If you have already completed winding of the backing line, skip this step and go to the next step by pressing
 200J (MEMO)
 200JL (PICKUP)

8. Firmly tie the main line to the backing line.

9. After adjusting the tension, turn the Jog Power Lever to the MAX position. and wind the main line up until the remaining line is 100 m, as checking the line color.

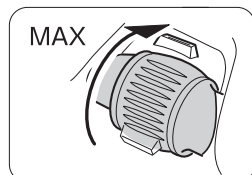

*While winding up the line, try to adjust the tension so that the mark ▼ stays around the screen center.

P2 Backing line input

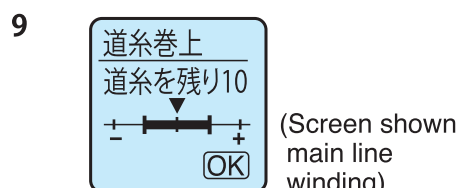
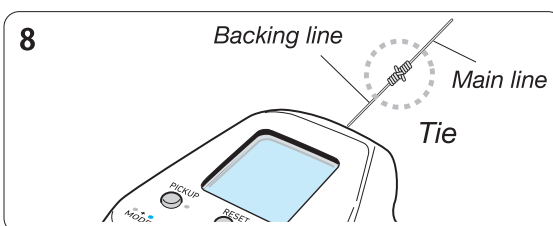
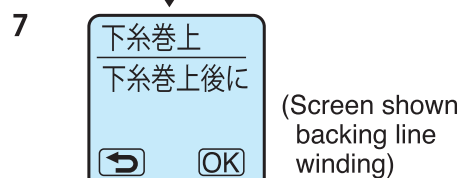
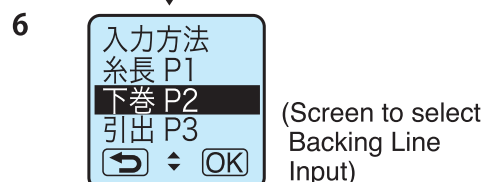
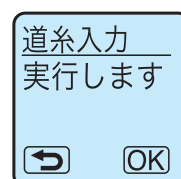

Functional setting [2. Main line input]

P2 Backing line input

Attention

- The reel may be damaged if the line touches the finger-guard or the frame. Keep the line from touching these components.
- Winding the line indoors for a prolonged period at a low speed with an elevated tension may cause the motor to overheat and thus fail. Please input by turning the Jog Power Lever to the MAX position. While actual fishing in outdoors, there is no need to worry about overheat problem because motor is cooled down by seawater, etc.

10. When winding is completed, turn the Jog Power Lever back to the OFF position and then press

200J ☐ (MEMO ☐ BUTTON)

200JL ☐ (PICKUP ☐ BUTTON)

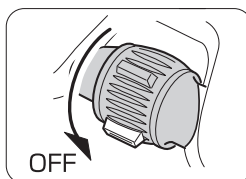

11. After adjusting the tension, turn the Jog Power Lever to the MAX position. Wind on another 50 m of line as checking the line color.

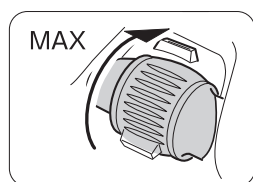

11

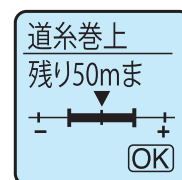

(Screen shown main line winding)

- *While winding up the line, try to adjust the tension so that the mark ▼ stays around the screen center.

12. When winding is completed, turn the Jog Power Lever back to the OFF position and then press

200J ☐ (MEMO ☐ BUTTON)

200JL ☐ (PICKUP ☐ BUTTON)

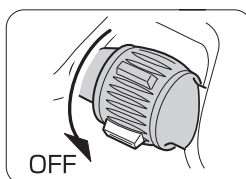

13. After adjusting the tension, turn the Jog Power Lever to the MAX position and wind the main line up to its end as checking the line color.

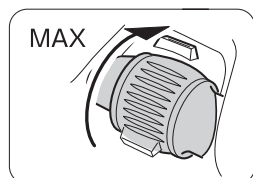

13

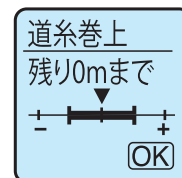

(Screen shown main line winding)



- *While winding up the line, try to adjust the tension so that the mark ▼ stays around the screen center.

Functional setting [2. Main line input]



P2 Backing line input

Attention

- Do not wind all the line. Before winding up all of the line, turn the Jog Power Level to the OFF position and then wind up the remaining line manually with the handle. Winding up all may cause an error with the counter.
- This winding method cannot be applied to lines thinner than PE 0.6.
- When winding a finer line below PE 2, the line may enter the gap between the spool and the frame it wound close to the spool's outer diameter; so, it is advisable to wind the line up to about 1mm inside the outer edge of the spool.

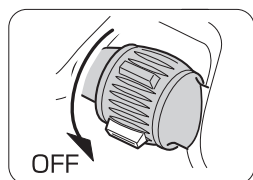

14. When winding is completed, turn the Jog Power Lever back to the OFF position and then press
 200J  (MEMO **BUTTON**)
 200JL  (PICKUP **BUTTON**) .

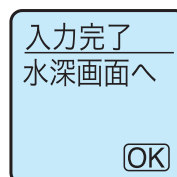

15. When "Complete" is displayed on the screen, press
 200J  (MEMO **BUTTON**)
 200JL  (PICKUP **BUTTON**)
 to return to the Water Depth screen and complete the data input of the line.

15



- * If "Error" appears on the screen while inputting the line data, press
 200J  (MEMO **BUTTON**)
 200JL  (PICKUP **BUTTON**)
 to return to the Water Depth screen and re-start the process from the beginning.

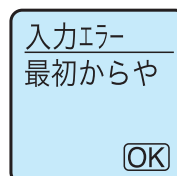

Functional setting [2. Main line input]

P3 Line re-input

This option allows you to re-enter the line data, pulling out the line after it has been completely wound up onto the reel.

Note that it is necessary that you know the line length and that it is greater than 60 m.

1. Pass the main line through the Level Wind and tie it to the spool.

- *The enclosed threading pin (See P12) facilitates the process.
- *Make sure to tie the line to the line stopper to prevent the line from slipping on the spool.
- *Tighten the drag.

2. Return the Jog Power Lever to OFF.

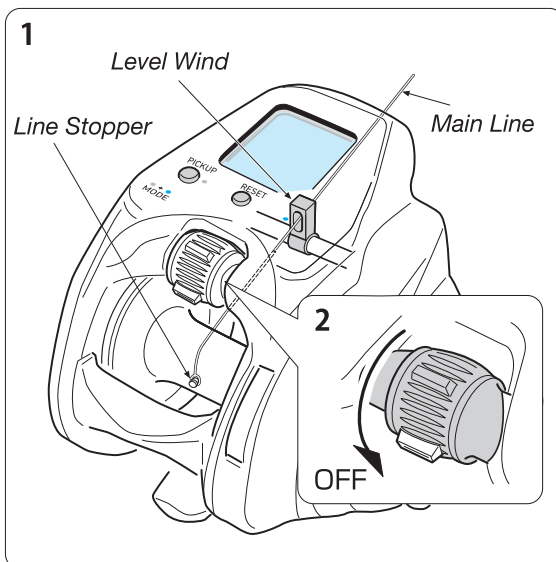

3. Turn on the reel.

- *Please refer to the page 8 “How to connect Power Supply” for the details of the connection method.

3



(The screen when the reel is switched on)

4. When 0.0 is displayed, press and hold the switches MEMO BUTTON and PICKUP BUTTON simultaneously for 2 seconds.

- *The figure shows 200J (in the case of 200JL, the buttons PICK UP and MEMO are reversely allocated).

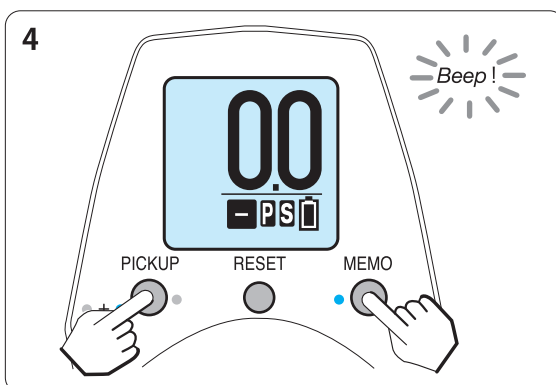

(Water Depth Screen)



Functional setting [2. Main line input]

5. Select "Line Input" with the Jog Power Lever and press

200J (MEMO **BUTTON**)

200JL (PICKUP **BUTTON**) .

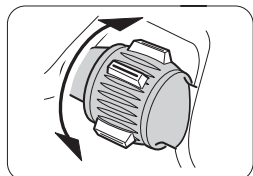

*By moving the Jog Power Lever, the selected item is highlighted on the screen.

*When the scrolling text 《Do you wish to continue?》 is displayed, press

200J (MEMO **BUTTON**)

200JL (PICKUP **BUTTON**)
one more time.

6. Select "Line re-input P3" and then press

200J (MEMO **BUTTON**)

200JL (PICKUP **BUTTON**) .

*The screen automatically switches to "Speed Range"

7. After adjusting the tension, turn the Jog Power Lever to the MAX position and then wind the main line.

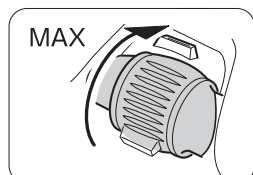

*While winding up the line, try to adjust the tension so that the mark ▼ stays around the screen center.

*When you have already completed winding the main line, simply press

200J (MEMO **BUTTON**)

200JL (PICKUP **BUTTON**) .

P3 Line re-input

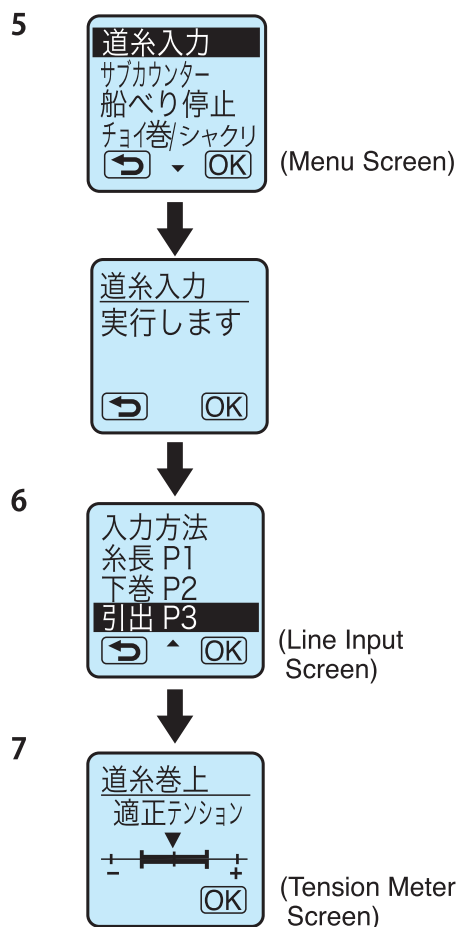

Attention

- The reel may be damaged if the line touches the finger-guard or the frame. Keep the line from touching these components.
- Winding the line indoors for a prolonged period at a low speed with an elevated tension may cause the motor to overheat and thus fail. Please input by turning the Jog Power Lever to the MAX position. While actual fishing in outdoors, there is no need to worry about overheat problem because motor is cooled down by seawater, etc.

Functional setting [2. Main line input]

P3 Line re-input

8. When winding is completed, turn the Jog Power Lever back to the OFF position and then press

200J (MEMO **BUTTON**)

200JL (PICKUP **BUTTON**)

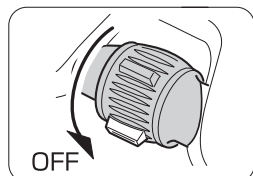

9. Pull 30 m of the line out of the reel as checking the line color and press

200J (MEMO **BUTTON**)

200JL (PICKUP **BUTTON**)

10. Pull another 30 m of the line out of the reel as checking the line color and press

200J (MEMO **BUTTON**)

200JL (PICKUP **BUTTON**)

11. When "Complete" is displayed on the screen, press

200J (MEMO **BUTTON**)

200JL (PICKUP **BUTTON**)

to return to the Water Depth screen. Wind up the line that you pulled out from the reel. If you wound it up, the procedure is completed.

*If "Error" appears on the screen while inputting the line data, press

200J (MEMO **BUTTON**)

200JL (PICKUP **BUTTON**)

to return to the Water Depth screen and re-start the process from the beginning.

9

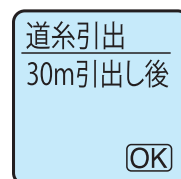

(Screen shown main line pulled out)

10

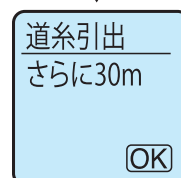

(Screen shown main line pulled out)

11

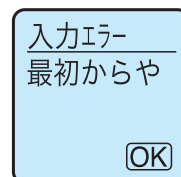
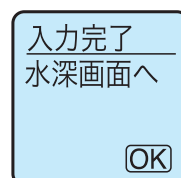

Attention

-Do not wind all the line. Before winding up all of the line, turn the Jog Power Level to the OFF position and then wind up the remaining line manually with the handle. Winding up all may cause an error with the counter.

-This winding method cannot be applied to lines thinner than PE 0.6.

-When winding a finer line below PE 2, the line may enter the gap between the spool and the frame it wound close to the spool's outer diameter; so, it is advisable to wind the line up to about 1mm inside the outer edge of the spool.

Functional setting [3. Sub counter]

Sub counter can be displayed below the Water Depth counter.

You can select one from 3 options; i.e. "Inverse counter", "Winding speed" and "Time to wind up"

*Sub counter is set to "No display" by default.

Inverse counter

You can easily identify a shelf in the strike zone for fishing with the distances from the boat and from the bottom by two counters.

1. Press and hold both **MEMO** **BUTTON** and **PICKUP** **BUTTON** simultaneously for 2 seconds to go to the Menu screen.
 ※The figure shows 200J
 (in the case of 200JL, the buttons PICK UP and MEMO are reversely allocated).
2. Select the option "Sub counter" with the Jog Power Lever and press
 200J **OK** (**MEMO** **BUTTON**)
 200JL **OK** (**PICKUP** **BUTTON**)
 Then, select "Inverse counter" and press
 200J **OK** (**MEMO** **BUTTON**)
 200JL **OK** (**PICKUP** **BUTTON**)

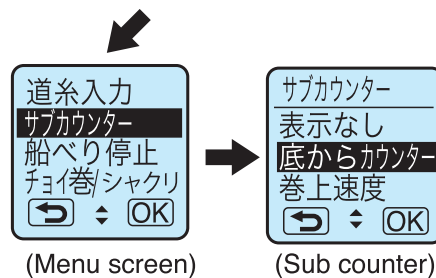
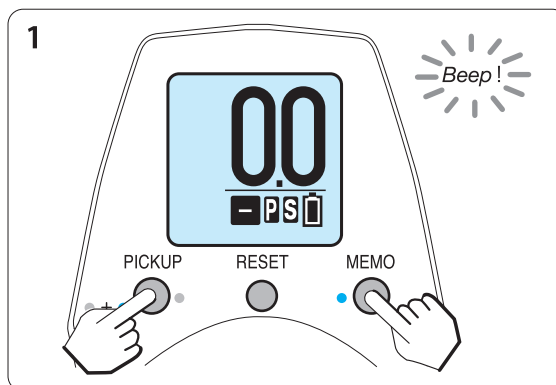
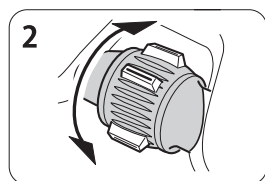

3. The Inverse counter will appear below the Water Depth counter.
4. When you press the **MEMO** **BUTTON** at the depth in the strike zone for fishing after lowering the terminal rig, including the bottom and your aiming shelf, the Inverse counter displays **0.0** as the reference point for showing the distance from such point.

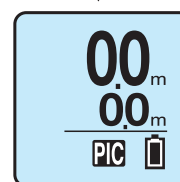

Functional setting [3. Sub counter]

Winding speed

This option displays the winding speed actually measured while the electrical winding up is in action.

1. Press and hold both **MEMO** **BUTTON** and **PICKUP** **BUTTON** simultaneously for 2 seconds to go to the Menu screen.

※The figure shows 200J
(in the case of 200JL, the buttons PICK UP and MEMO are reversely allocated).

2. Select the option "Sub counter" with the Jog Power Lever and press
200J **OK** (**MEMO** **BUTTON**)
200JL **OK** (**PICKUP** **BUTTON**)
Then, select "Winding speed display" and press
200J **OK** (**MEMO** **BUTTON**)
200JL **OK** (**PICKUP** **BUTTON**) .

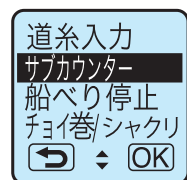
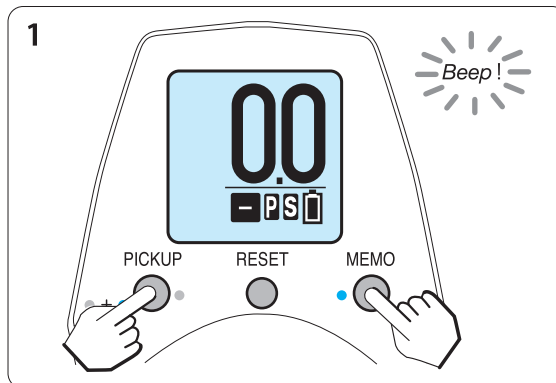
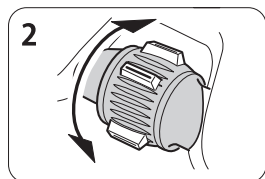

(Menu screen)

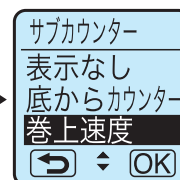

(Sub counter)

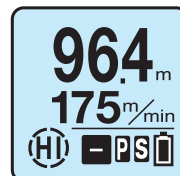

(Example of display)

3. The winding speed will be displayed below the Water Depth counter.

*This is displayed only while electrical winding up is in action.

Functional setting [3. Sub counter]

Time to wind up

This option displays the timer roughly indicating the remaining time to auto stop at the boat side.

*A gap in the time may be caused by the fluctuation of the actual winding speed.

1. Press and hold both **MEMO** **BUTTON** and **PICKUP** **BUTTON** simultaneously for 2 seconds to go to the Menu screen.

※The figure shows 200J
(in the case of 200JL, the buttons PICK UP and MEMO are reversely allocated).

2. Select the option "Sub counter" with the Jog Power Lever and press
200J **OK** (**MEMO** **BUTTON**)
200JL **OK** (**PICKUP** **BUTTON**)
Then, select "Time to wind up" and press
200J **OK** (**MEMO** **BUTTON**)
200JL **OK** (**PICKUP** **BUTTON**) .

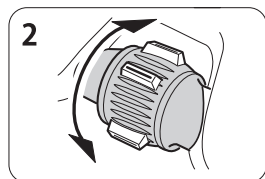

3. The time to wind up will be displayed below the Water Depth counter.

*This is displayed only while electrical winding up is in action.

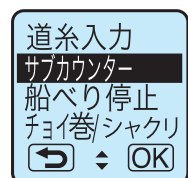
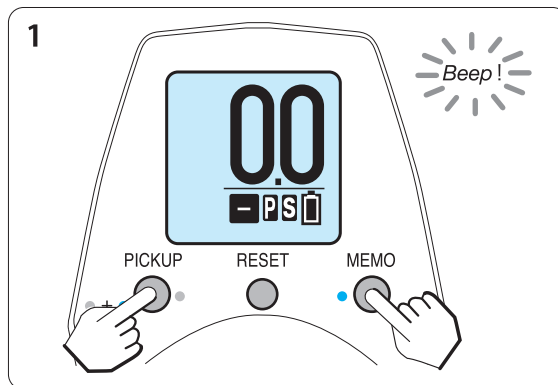

(Menu screen)

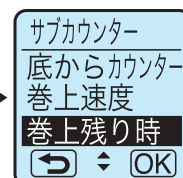

(Sub counter)

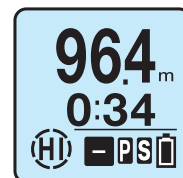

(Example of display)

Functional setting [4. Before start fishing]

Water surface zero setting

Before you start fishing, always perform this zero setting to identify a more accurate depth of the strike zone for fishing.

1. Connect the reel to the battery. Pass the line through all the guides, and prepare your terminal rig.
2. Lower the terminal rig to the water surface and press the **RESET** **BUTTON**.

The display resets to **0.0** and the indicator lamp **S** (auto stop) will turn on. Then the setup has been completed.

While electrical winding up is in action, winding will automatically stop at 2 m before auto stop at the boat side.

*If this “Water surface zero setting” is not made, winding will automatically stop at 5 m before the auto stop point for safety.

*After auto stop at the boat side, the Jog Power Lever will be disabled to wind up the line to prevent the rig from being accidentally wound up due to miss operation.

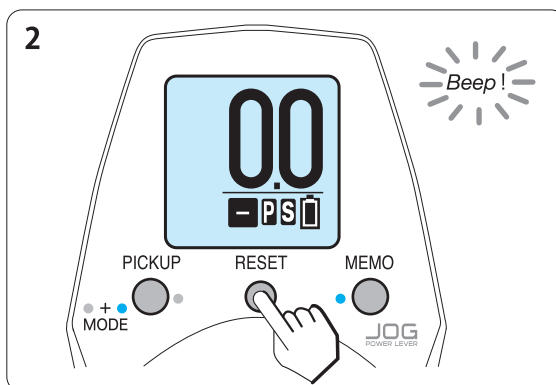
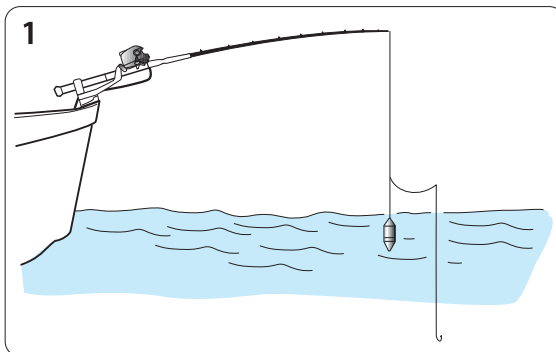

Attention

- When new line is wound up, or when line has been pulled under heavy tension, line stretch may cause a gap in the auto stop point at the boat side. Simply reset the surface setting to set it to zero.
- Depending upon the rolling of the boat or sinker weight, auto stop point can overrun slightly. Should this happen, increase the depth of the auto stop.
- Fishing at a depth over 328 ft (100 m) with a load largely fluctuating may cause a gap in the stop point. Thus, the terminal rig may be accidentally wound up and the rod may be broken. In such fishing, it is recommended to have sufficient margin in setting of auto stop point to avoid such events.

If the main line is broken

-Should your line break, revise data as follows.

Revise the data of the broken line. Wind the line to the rod tip while the reel is powered on. Then, press the **RESET** **BUTTON** for 2 seconds or more. When the display shows **0.0**, then your re-adjustment is completed.

*The line data will be overwritten (revised) by the procedure described above.

*Do not press and hold the **RESET** **BUTTON**, except for data correction of a broken line; it may cause an error in the counter.

Functional setting [5. Auto stop]

Adjustable auto stop setting

The auto stop point can be set to meet your own specific needs and ease your preparatory works such as checking and changing of baits and sinkers.

-You can set the auto stop point by setting the adjustable depth within the range 1 to 5 m from the point where you press **RESET BUTTON** (in 10 cm increments).

Especially in case of chumming, it is recommended to set the adjustable auto stop point so that a chumming bait sinker comes to your hand side when you raise your rod tip, for more convenient checking and changing of baits and sinkers.

Note that it is designed not to allow you to set the auto stop point to any value below 1 m for safety reasons.

-In the case when you feel the auto stop point comes down due to line stretch, simply reset the counter to zero at the water surface.

-Note that the Jog Power Lever may not be allowed to manipulate around the auto stop point for safety reasons.

There are two different ways to set the adjustable auto stop; setting in the Menu screen and setting in the Water Depth screen.

● Setting in the Menu screen

1. Press and hold both **MEMO BUTTON** and **PICKUP BUTTON** simultaneously for 2 seconds to go to the Menu screen.

※The figure shows 200J
(in the case of 200JL, the buttons PICK UP and MEMO are reversely allocated).

2. Select "Auto Stop" with the Jog Power Lever and press

200J **OK** (**MEMO BUTTON**)

200JL **OK** (**PICKUP BUTTON**) .

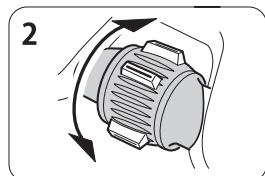

3. Then, select your desired auto stop point with the Jog Power Lever and press

200J **OK** (**MEMO BUTTON**)

200JL **OK** (**PICKUP BUTTON**)

to return to the Water Depth screen.

*You are not allowed to set the adjustable auto stop if you have not yet set the water surface zero setting. Be sure to carry out the water surface zero setting.

4. If you carry out electrical winding up after lowering the terminal rig, your terminal rig will automatically stop at the pre-set point.

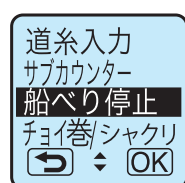
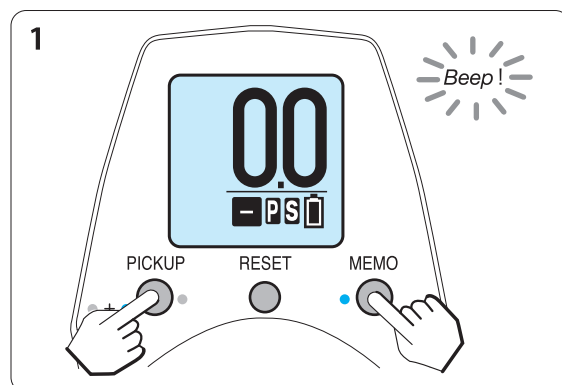

(Menu screen)



(Example of display)

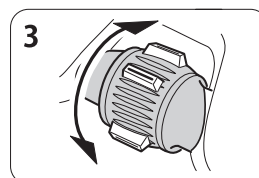

Functional setting [5. Auto stop]

● Setting in the Water Depth screen

1. While the reel is powered on and your terminal rig is on the water surface, press the **RESET** **BUTTON** (water surface zero setting).

The display will show **0.0** .

※The figure shows 200J
(in the case of 200JL, the buttons PICK UP and MEMO are reversely allocated).

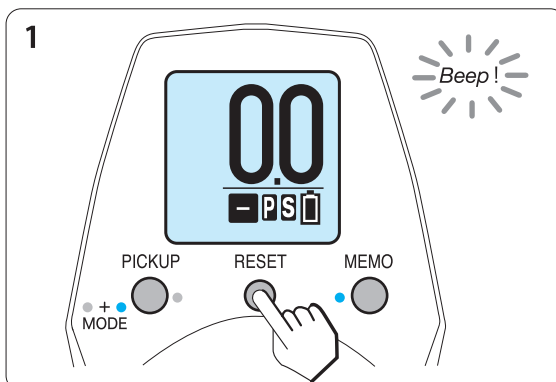

2. Raise your rod tip and pull the line out adjusting the line length from the rod tip so that you can reach the rig easily.

In the figure, its length is 1.5 m.

Use

Chumming

It is recommended to set the auto stop so that a chumming bait sinker comes to your hand side when you raise your rod tip, for more convenience for checking and changing of baits and sinkers.

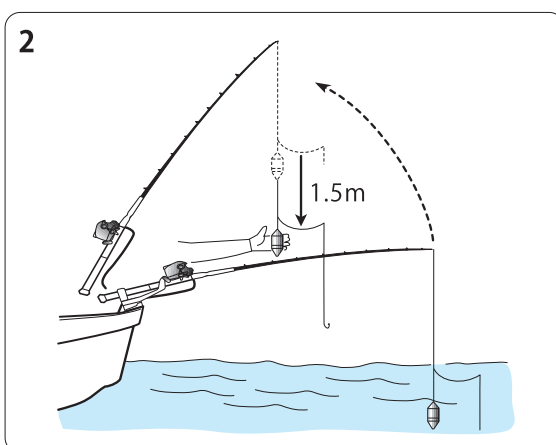

3. When the line length has been properly adjusted, press and hold the **MEMO** **BUTTON** for about 2 seconds.

When the indicator lamp **S** (auto stop at boat) blinks, the setting is completed.

*Auto stop is set to 2.0 m by default.

(If **RESET** **BUTTON** is not pressed, the reel stops at 5.0 m)

*If the setting is completed, the indicator lamp **S** (auto stop at boat) will blink.

※The figure shows 200J
(in the case of 200JL, the buttons PICK UP and MEMO are reversely allocated).

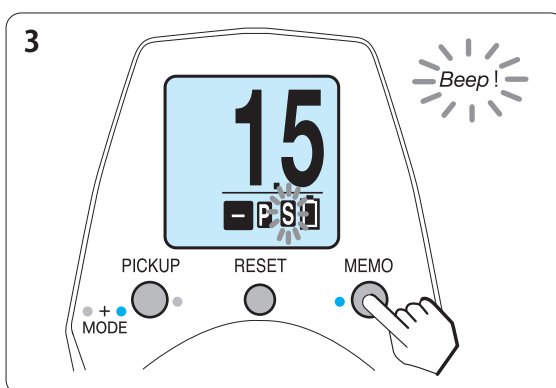

4. The electrical winding up automatically stops at the pre-set point. So, raise the rod tip to bring your terminal rig to your hand side.

Functional setting [6. Motor ON/OFF Interlocking Clutch]

The motor rotation stops when the clutch is turned OFF during electric winding (while the motor is rotating). The electric winding (motor rotation) automatically restarts when the clutch is turned ON again. This captures sensitive signals of hits and strikes such as fish-bite and squid-touch while the jig is falling.

How to operate Motor ON/OFF Interlocking Clutch

1) Operation while the clutch is turned OFF (motor is stopped)

You can set the wind-up speed (1 to Hi) with the JOG Power Lever while the water depth is 9.1 m or more.

*The value shown at the left bottom of the counter screen blinks.

When the clutch is turned ON, electric winding is started at the set wind-up speed (motor rotation).

2) Operation while the clutch is OFF (motor rotation)

You can set the wind-up speed (1 to Hi) with the JOG Power Lever while the water depth is 9.1 m or more.

* The value shown at the left bottom of the counter screen blinks.

* Electric wind-up is performed at the set wind-up speed (motor rotation).

When the clutch is turned OFF, electric winding stops (motor stop).

You can alternately and repeatedly turn the clutch ON (motor rotation) or OFF (motor stop).



WARNING <Warning for your use of the product>

•Your fingers may be pinched or rolled in while the clutch is turned ON. Immediately turn OFF the Lever to stop the operation.



CAUTION <Caution for your use of the product>

**Do not turn the clutch ON while the line is tangled around the rod tip. Otherwise, the rod tip may be broken.*

**Do not turn the clutch ON while the line is backlashed. Otherwise your reel may be broken.*



CAUTION <Caution for your operation>

**When the line is wound up to the point of water depth less than 9.0 m while repeating the winding, the wind-up speed will be reset.*

In such case, set it again.

**The set wind-up speed is disabled during the operation in Jerking or Pickup mode.*

Functional setting [7. Pickup / Pause]

Pickup

This is very useful. You can wind the line by the electric reel only while pressing the **PICKUP BUTTON**. The pickup speed is set to 15 by default. You can change it in the Menu screen.

Pause

This is very useful. You can pause the electrical winding up only while pressing the **PICKUP BUTTON**. When you release the button, the reel restarts winding up at the speed specified by using the Jog Power Lever.

Pickup / Pause setting

1. Press and hold both **MEMO BUTTON** and **PICKUP BUTTON** simultaneously for 2 seconds to go to the Menu screen.

※The figure shows 200J
(in the case of 200JL, the buttons PICK UP and MEMO are reversely allocated).

2. Select "Pickup/Jigging" with the Jog Power Lever and press
200J **OK** (**MEMO BUTTON**)
200JL **OK** (**PICKUP BUTTON**).
Then, select "Pickup" from the Pickup/Jigging options and press
200J **OK** (**MEMO BUTTON**)
200JL **OK** (**PICKUP BUTTON**).

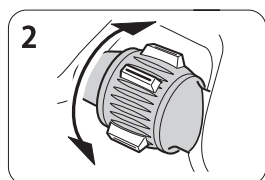

3. Set the speed with the Jog Power Lever.

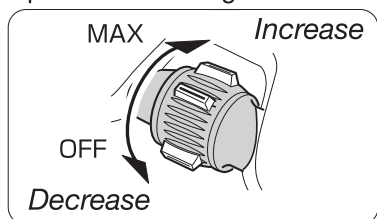

You can set the speed to any value in the range from 1 to Hi (in the figure, the speed is set to 20). Set it to 1 to Hi to make the reel in the Pickup mode or otherwise set it to 0 to make the reel in the Pause mode.

4. Press
200J **OK** (**MEMO BUTTON**)
200JL **OK** (**PICKUP BUTTON**)
to return to the Water Depth screen. Now, the setting is completed.

※Note that it is designed not to allow you to wind-up within the range auto stop point + 3m for safety reasons.

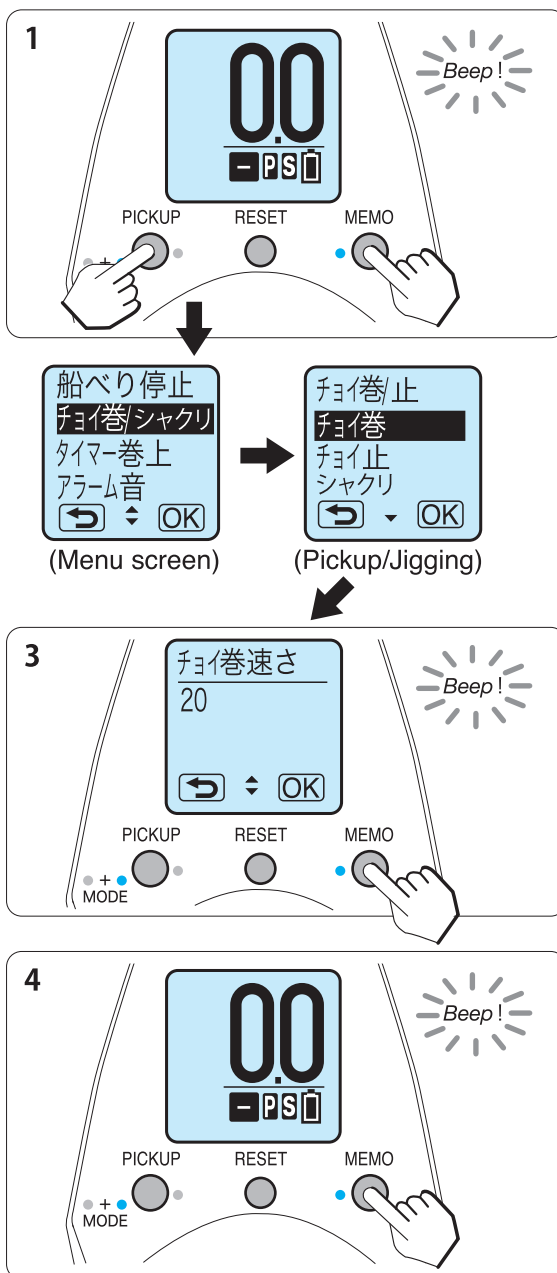

Functional setting [8. Jigging]

Jigging

This function is useful to let the reel control the line so as to slack and jig the line to attract fish. Once you have set up this function, the reel starts jigging when you press the **PICKUP BUTTON**. You can adjust the jigging speed by using the Jog Power Lever.

1. Press and hold both **MEMO BUTTON** and **PICKUP BUTTON** simultaneously for 2 seconds to go to the Menu screen.

※The figure shows 200J
(in the case of 200JL, the buttons PICK UP and MEMO are reversely allocated).

2. Select "Pickup/Jigging" with the Jog Power Lever and press
200J **OK** (**MEMO BUTTON**)
200JL **OK** (**PICKUP BUTTON**).
Then, select "Jigging" and press
200J **OK** (**MEMO BUTTON**)
200JL **OK** (**PICKUP BUTTON**).

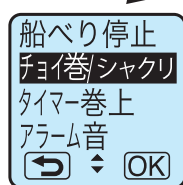
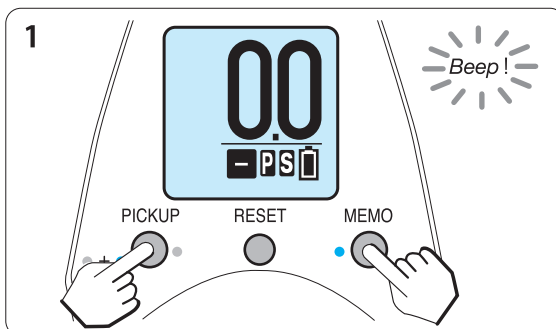
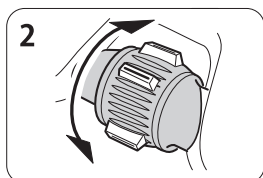

(Menu Screen)

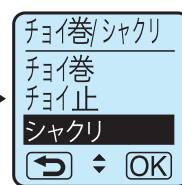

(Pickup/Jigging)

3. Select any pattern from the Jigging Pattern options with the Jog Power Lever and press
200J **OK** (**MEMO BUTTON**)
200JL **OK** (**PICKUP BUTTON**).

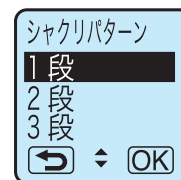
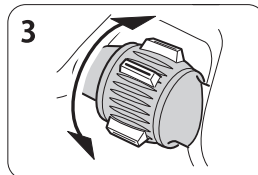

(Jigging Patterns)

You can select the number of steps per a length of the line wound up in a single cycle of jigging.

One-step jigging	Two-step jigging	Three-step jigging	Random jigging
			<p>Random jigging is the method in which the number of jigging steps from 1 to 3 is randomly and automatically selected by the IC system to attract fish. It is a marvelous auto jigging mechanism.</p>

A : 4 seconds stop B : 0.4 seconds stop

*In the figure, a rod is used to represent the jigging but actually the line is jigged and wound up by the reel.

Functional setting [8. Jigging]

4. Set the Jigging length with the Jog Power Lever and press
 200J (MEMO)
 200JL (PICKUP) .

You can select the length of the line wound up in a single cycle of jigging (the length may slightly overrun its preset length depending on the sinker or winding speed).

*The jigging length can be set to any value between 0.1 and 10.0 m.

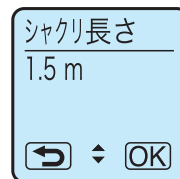
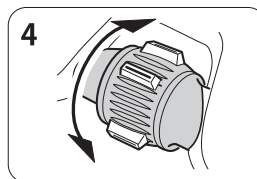

(Example of display)



5. Set the Jigging Speed with the Jog Power Lever and press
 200J (MEMO)
 200JL (PICKUP) .

You can choose the jigging "speed".

-If you set the Jigging Speed between 1 and Hi, your line will be wound up at the preset speed.

-If you set the Jigging Speed to 0, you can adjust the speed with the Jog Power Lever.

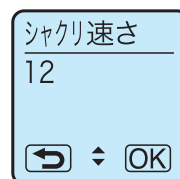
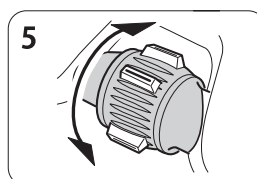

(Example of display)



6. Set the interval time with the Jog Power Lever and press
 200J (MEMO)
 200JL (PICKUP) .

You can select the interval time (waiting time) between jigging cycles.

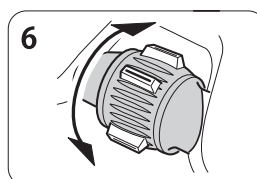

(Example of display)

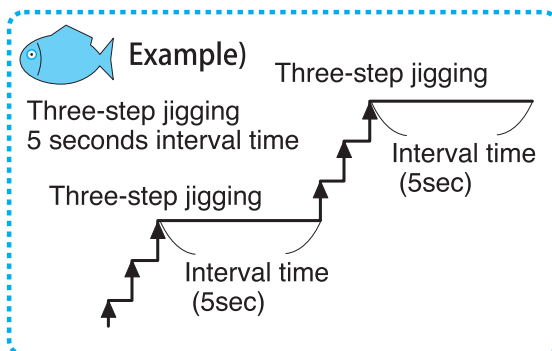

Attention

If the time preset to "chumming timer winding time" is shorter than the jigging time (in seconds), then the chumming timer setting takes priority to wind up the line.

Functional setting [8. Jigging]

7. Set the jigging range with the Jog Power Lever and press
 200J **OK** (**MEMO** **BUTTON**)
 200JL **OK** (**PICKUP** **BUTTON**)
 to return to the Water Depth screen. Now, the setting is completed.

You can select the range of jigging.

*If you have set the range to OFF, jigging will be continuously performed to the auto stop point.

*If you have set the range to any value, jigging will be performed only for the specified range.

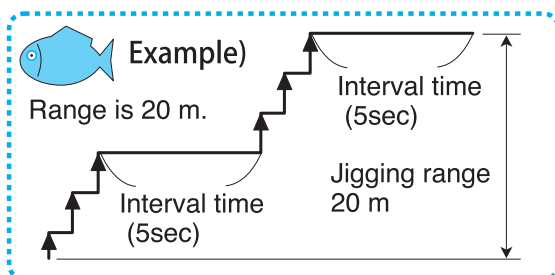

7. After lowering the terminal rig, press the **PICKUP** **BUTTON** and set the jigging speed with the Jog Power Lever. Then, the reel will start jigging.

- The indicator **JIG** (Jigging) is blinking while the line is being wound up in the jigging mode.
- If you have set the Jigging Speed to "0", adjust the Jigging Speed with the Jog Power Lever.
- If you press the **PICKUP** **BUTTON** during jigging operation, the jigging will stop.

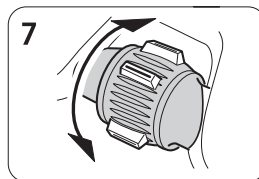

(Example of display)



Functional setting [9. Chumming Timer]

Chumming Timer

The display shows precisely the time having elapsed every since the rig was dropped. It is very helpful to determine the pace for checking and changing of baits and sinkers.

- The display shows the time having elapsed since lowering of the rig started. You can roughly estimate the timing to chum or collect the rig.
- The Chumming Timer automatically starts from 7.0 m displayed on the water surface counter after throwing your terminal rig into the water.

- *The time is indicated in seconds if the remaining time is less than 60 seconds. It is indicated in minutes if the remaining time is not less than 1 minute.
- *The timer function may not be reset.
- *For proper use of the timer, your next terminal rig feeding shall be made only after winding it up to the auto stop position at the boat side.

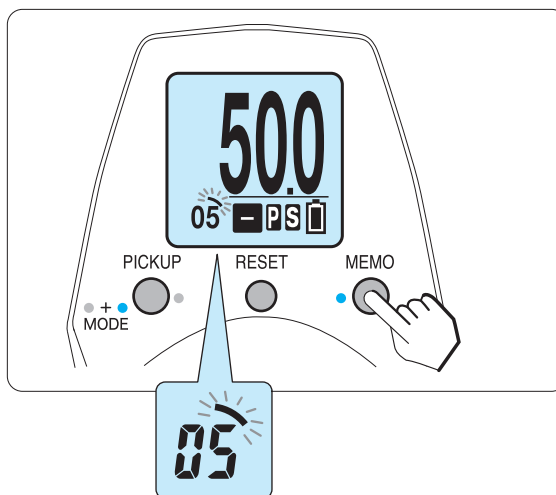

Attention

If you press the **MEMO** **BUTTON** while chumming is in process, the timer indication will start from **0** .

Functional setting [10. ChummingTimer winding]

Chumming Timer Winding

Professional fishing techniques of checking and changing of baits and sinkers for all levels including beginners! Once you have set the waiting time simply, the reel automatically starts winding up. You can enjoy fishing more effectively and easily.

-If you have set the waiting time for a single chumming to 5 minutes, the reel will automatically start winding up at a high speed to allow you to check and change baits and sinkers after preset 5 minutes have passed.

1. Press and hold both **MEMO BUTTON** and **PICKUP BUTTON** simultaneously for 2 seconds to go to the Menu screen.

※The figure shows 200J
(in the case of 200JL, the buttons PICK UP and MEMO are reversely allocated).

2. Select the "Timer Winding" with the Jog Power Lever and press
200J **OK** (**MEMO BUTTON**)
200JL **OK** (**PICKUP BUTTON**).

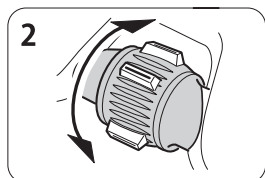

3. Select the waiting time (in minute) for checking and changing of baits and sinkers with the Jog Power Lever.

Turn the Jog Power Lever upward to increase the value. Or, turn it downward to decrease the value. (In the figure, the waiting time is set to 5 minutes)

4. Press
200J **OK** (**MEMO BUTTON**)
200JL **OK** (**PICKUP BUTTON**).
If the screen returns to the "Water Depth screen", then the setting is completed.

The indicator **T** (Timer) will light up on the screen.

5. The reel will automatically starts winding up the rig at its maximum speed when the preset time has elapsed while the clutch is powered on after lowering the terminal rig.

-An audible alarm will sound before the reel starts winding.

-If the clutch is powered OFF, the reel will not start automatic winding up.

-The chumming timer automatically starts when the depth counter determined the depth 7.0 m. But, you can reset the timer and restart it by pressing **MEMO BUTTON**.

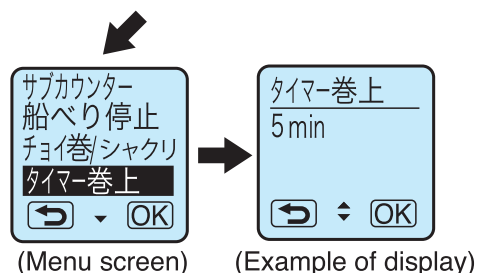
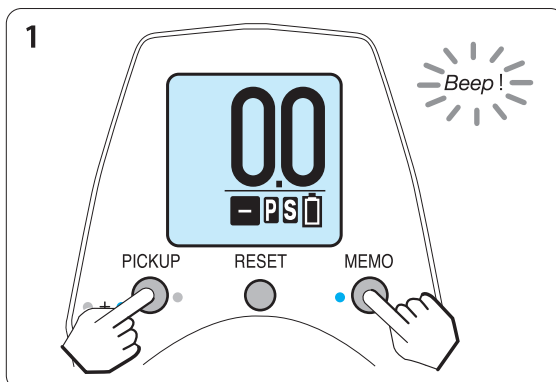

-For proper use of Timer winding function, press **MEMO BUTTON** when your terminal rig has reached the strike zone.

Functional setting [11. Drag Sound]

This is a function to alert you by electronic beep when the drag is pulled out. You can select one from three types of alarm sounds and OFF. It is set to "Pattern 1" (High-tone) by default.

Options for Drag Sound

Pattern 1: High-tone
Pattern 2: Middle tone
Pattern 3: Low-tone
OFF: No alarm beeping

How to set Drag Sound

1. Press and hold both **MEMO** **BUTTON** and **PICKUP** **BUTTON** simultaneously for 2 seconds to go to the Menu screen.

*The figure shows 200J
(in the case of 200JL, the buttons PICK UP and MEMO are reversely allocated).

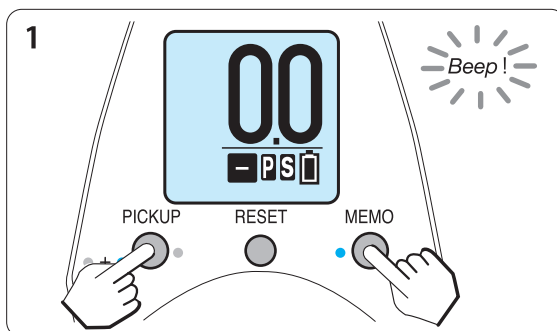

2. Select "Drag Sound" with the Jog Power Lever and press
200J **OK** (**MEMO** **BUTTON**)
200JL **OK** (**PICKUP** **BUTTON**) .

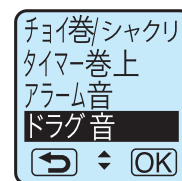
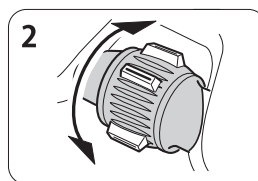

(Menu screen)

3. Select one of options for "Drag Sound" and press
200J **OK** (**MEMO** **BUTTON**)
200JL **OK** (**PICKUP** **BUTTON**) .

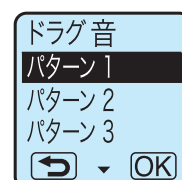
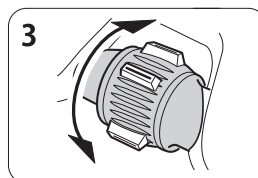

(Menu screen)

*It is set to "Pattern 1" by default.

Functional setting [12. Depth Alarm]

This is a function to inform you the water depth counted every 10 m by alarm beeping. You can select the alarm setting for both Fall (FL) and Wind-up (UP).

* It is set to "FL 1" and "UP 1" by default.

Options for Alarm Sound

You can select one of four options for Alarm Sound including alarm beep OFF.

(1)FL/UP 0: Alarm beep OFF

(2)FL/UP 1: One beep repeated every 10 m of water depth

(3)FL/UP 3: One to three beeps repeated every 10 m of water depth

(4)FL/UP 5: One to five beeps repeated every 10 m of water depth

The options (1) to (4) can be set for each of Fall and Wind-up to ON or OFF.

How to set Depth Alarm

1. Press and hold both **MEMO** **BUTTON** and **PICKUP** **BUTTON** simultaneously for 2 seconds to go to the Menu screen.

*The figure shows 200J
(in the case of 200JL, the buttons PICK UP and MEMO are reversely allocated).

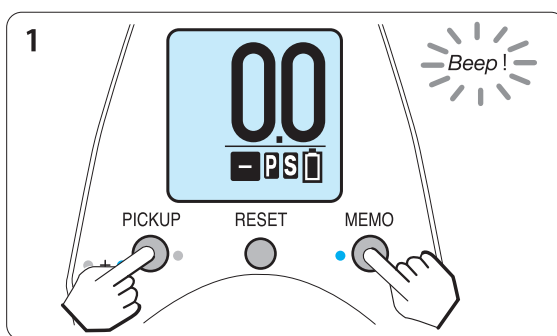

2. Select "Depth Alarm" with the Jog Power Lever and press
200J **OK** (**MEMO** **BUTTON**)
200JL **OK** (**PICKUP** **BUTTON**) .

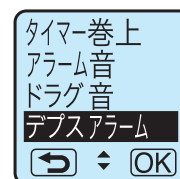
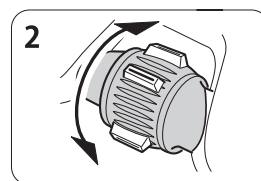

(Menu screen)

3. Select "ON" under "Depth Alarm" with the Jog Power Lever and press
200J **OK** (**MEMO** **BUTTON**)
200JL **OK** (**PICKUP** **BUTTON**) .

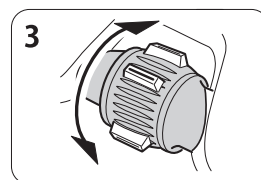

(Menu screen)

4. Select one of options for "Depth Alarm (Fall)" and press
200J **OK** (**MEMO** **BUTTON**)
200JL **OK** (**PICKUP** **BUTTON**) .

** It is set to "FL 1" by default.

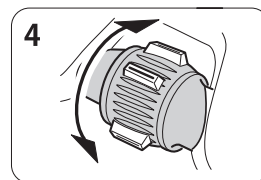

(Menu screen)

5. Select one of options for "Depth Alarm (Wind-up)" and press
200J **OK** (**MEMO** **BUTTON**)
200JL **OK** (**PICKUP** **BUTTON**) .

** It is set to "UP 1" by default.

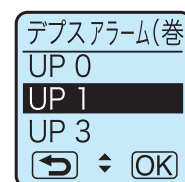
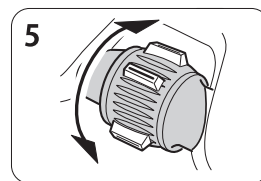

(Menu screen)

Functional setting [13. Water depth recalibration]

Water depth recalibration

You can recalibrate the counter if it does not match the depth identified by the color markings on your line.

Use

You can recalibrate the counter while you are fishing!

(Example) To recalibrate the counter to 100 m to comply with the depth identified as just 100 m by the color of the line, though the counter shows 103 m.

1. When the water depth to be corrected is displayed, press and hold both **MEMO BUTTON** and **PICKUP BUTTON** simultaneously for 2 seconds to go to the Menu screen.

※The figure shows 200J
(in the case of 200JL, the buttons PICK UP and MEMO are reversely allocated).

2. Select the "Water depth recalibration" with the Jog Power Lever and press
200J **OK** (**MEMO BUTTON**)
200JL **OK** (**PICKUP BUTTON**) .

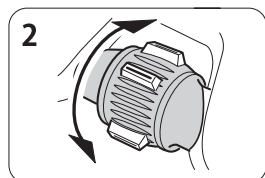

*The scrolling text 《Do you wish to continue?》 is displayed. If you confirm the choice, press
200J **OK** (**MEMO BUTTON**)
200JL **OK** (**PICKUP BUTTON**)
again.

*Any correction cannot be made if the water depth is less than 10.0 m.

3. Select your desired water depth with the Jog Power Lever and press
200J **OK** (**MEMO BUTTON**)
200JL **OK** (**PICKUP BUTTON**)
to return to the Water Depth screen.

4. Now, the water depth has been corrected.

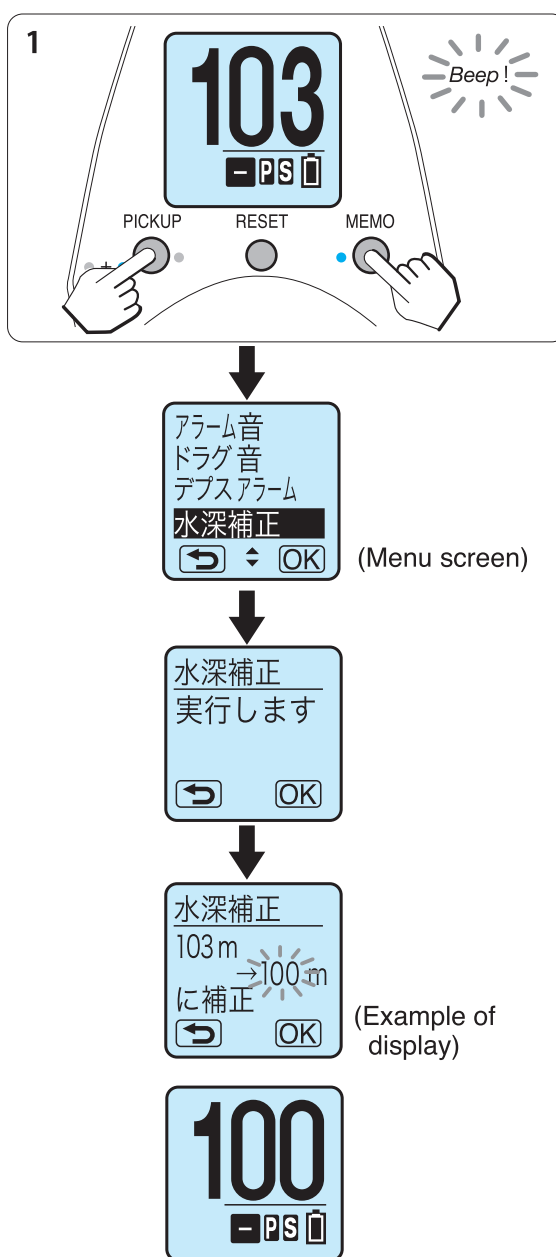

Functional setting [14. Actual fishing history]

Actual fishing history

You can check the total winding distance and the total hours of fishing using the electric reel.

1. Press and hold both **MEMO** **BUTTON** and **PICKUP** **BUTTON** simultaneously for 2 seconds to go to the Menu screen.

*The figure shows 200J
(in the case of 200JL, the buttons PICK UP and MEMO are reversely allocated).

2. Select the "Actual fishing history" with the Jog Power Lever and press
200J **OK** (**MEMO** **BUTTON**)
200JL **OK** (**PICKUP** **BUTTON**) .

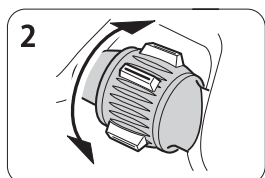

3. You can check the total winding distance and the total hours of fishing using the electric reel. Press
200J **OK** (**MEMO** **BUTTON**)
200JL **OK** (**PICKUP** **BUTTON**)
to return to the Water Depth screen.

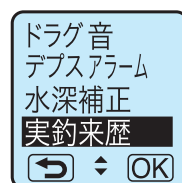
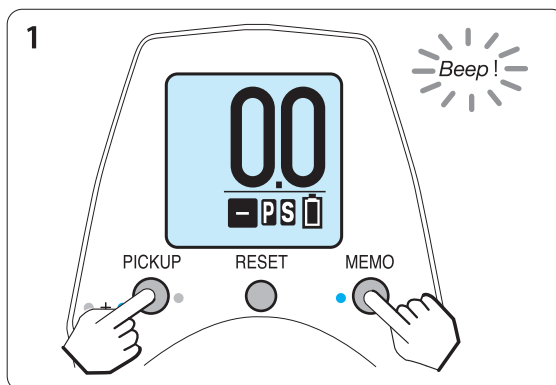

(Menu screen)



(Example of display)

Functional setting [15. Other useful functions]

Various alarms

Many kinds of information are indicated by audible alarms such as auto stop alarm and range memory alarm.



Jog Power Lever alarm

-When you place the Jog Power Lever at MAX or OFF position, an alarm beeps to tell you its position.

Auto stop alarm

-While winding up, an alarm shortly beeps starting 6 m below the auto stop point, at two meter intervals, to tell you that the rig is coming closer to the auto stop point. When it reached the auto stop point, an alarm sounds for longer.

Range memory alarm

-While lowering your rig back into the strike zone, an alarm shortly beeps starting 10 m above the memorized depth range of the strike zone, at 2 m intervals, to tell you that the rig is reaching closer to the strike zone. When the rig reached the strike zone, an alarm sounds for longer.

*This zone memory alarm is designed not to sound unless the line has been wound more than 6 m above the memorized depth and the line is fed again for the purpose of preventing the alarm from frequently sounding while seeking the strike zone.

-Fishing Zone alarm is enabled by setting "Inverse counter" from the "Sub counter" menu to set it.

Switch alarm

-Each time a button is pressed, a beep is sounded to allow you to confirm that you have surely pressed a button (You can set this alarm to OFF in the setting of functions from the Menu screen).

Excessive voltage alarm

-If you connected a power source with a voltage higher than the acceptable range, a continuous alarm will sound to warn you to stop operation. DO NOT operate the reel with such battery.

Timer winding alarm

-This alarm sounds to tell you before starting a timer winding.

Alarm sound ON/OFF setting

You can set the alarm sound to OFF.

-It is set to ON by default.

-Once the alarm sound has been set to OFF, the alarm will no longer sound even if you have pressed buttons or have used the power lever for operation.



1. Select "Alarm sound" in the Menu screen.
2. Select OFF with the Jog Power Lever.
3. Press

200J (MEMO)

200JL (PICKUP) .

If the screen returns to the "Water Depth screen", then the setting is completed.

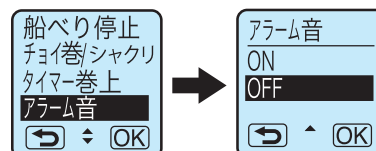

Functional setting [15. Other useful functions]

Language setting

You can select the language to be displayed on the LCD screen from Japanese, English, Traditional Chinese, Simplified Chinese or Korean.

1. Select "Language" in the Menu screen.
2. Select your desired language with the Jog Power Lever.
3. Press
200J (MEMO)
200JL (PICKUP).

If the screen returns to the "Water Depth screen", then the setting is completed.

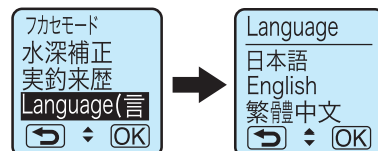

Unit setting

You can select "m" (meter) or "ft" (feet) for a unit to be used for the length.

*Note that the unit is represented in "m" (in meters) only when entering a value in "Main line input" even if "ft" (in feet) has been set for the unit.

1. Select "Unit" in the Menu screen.
2. Select your desired language with the Jog Power Lever.
3. Press
200J (MEMO)
200JL (PICKUP).

If the screen returns to the "Water Depth screen", then the setting is completed.

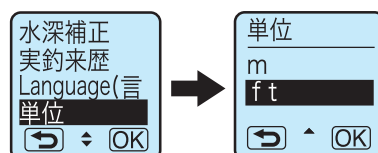

Indication of manual winding speed

The value of manual winding speed is indicated on the counter.

* See circled point (●) on the right sketch.

-Value indication: From 1 to 10

*NOTE: Manual winding speed is not indicated when power winding-up or timer winding-up is set.

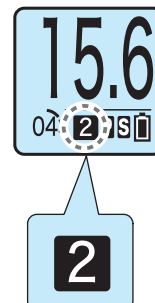

Counter lamp

The lamp built in the counter always lights up.

-While the reel is powered ON, backlighting of the display always provides easier reading for fishing in the dark.

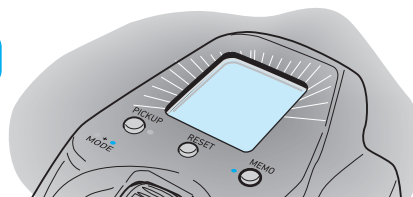

Circuit breaker display

-When an excessive heavy load is applied on the reel or an excessive temperature rise is detected, the circuit breaker will be tripped and the winding operation will be stopped to prevent damage to the reel body. It stops for 5 seconds if an excessive load is applied, or for 15 seconds if an excessive temperature rise occurs.



(Indicator is blinking)

Functional setting [16. How to remove the handle knob] (Single handle)

1. Holding the handle knob with your hand, loosen the handle knob cap by turning it counter-clockwise to loosen using a coin and remove it.

*Be sure to fit a coin properly onto the groove on the handle knob cap before turning it. Otherwise, the handle knob cap will be damaged while turning it.

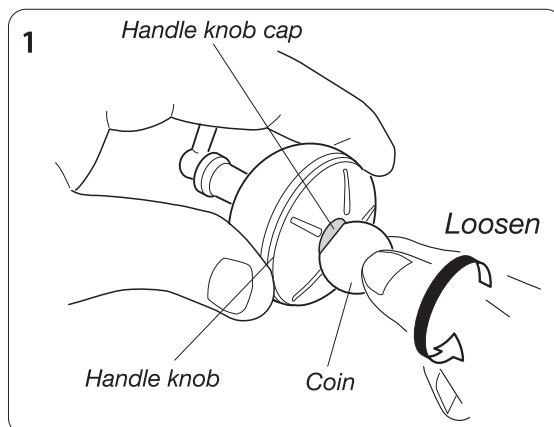

2. Loosen and remove the screw fixed inside of the knob using a screw driver.

*Note that the screw is coated with a slack preventing agent and it is hardly loosened. Be careful not to damage the screw head.

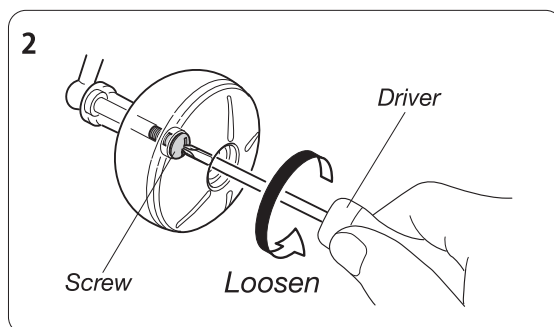

3. The handle knob is composed of as shown in the figure.

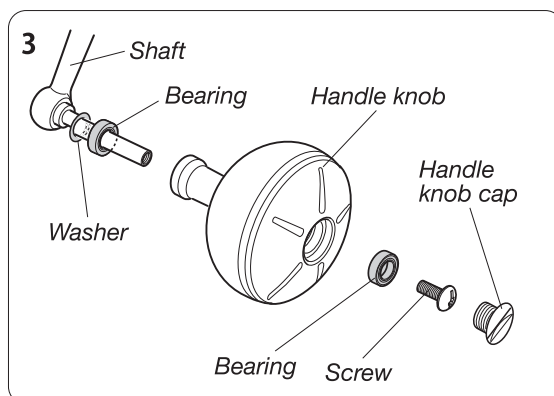

Functional setting

[17. How to remove the handle knob] (Double handle)

1. Loosen and take out the handle knob cap with the attached tool, while pushing the handle knob by hand.

*Beware that the nail is a retort. And turn the attached tool with itself tightly fit into the handle knob cap, as otherwise the handle knob cap will be hurt.

1

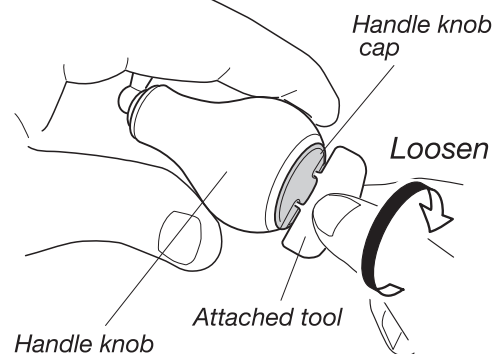

2. Loosen and remove the screw fixed inside of the knob using a screw driver.

*Note that the screw is coated with a slack preventing agent and it is hardly loosened. Be careful not to damage the screw head.

2

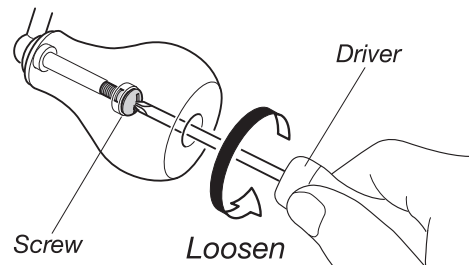

3. The handle knob is composed of as shown in the figure.

3

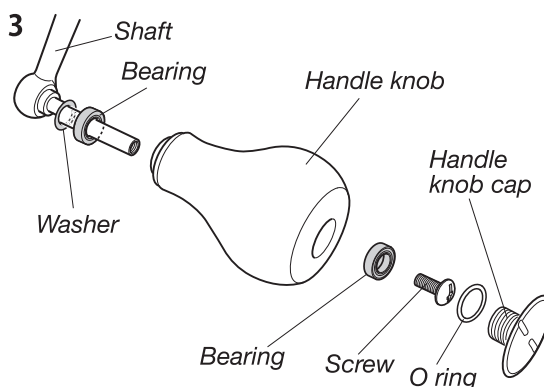

Reel Specifications

Reel Specification list

SEABORG 200J/JL

Product name			200J	200JL	200J-DH	200JL-DH
			00810026	00810027	00810028	00810029
Gear ratio(manual winding)			5.1:1			
Weight (g)			J/JL:490		J-DH/JL-DH:485	
Max Drag power (kg)			10			
Line Capacity (m)	PE (model-m)	1	600			
		1.5	450			
		2	300			
		3	200			
	Nylon (lb-m)	3	250			
		4	170			
Number of ball bearings (Ball / Roller)			12/1			
Power-supply voltage			DC12V~16.8V			
Maximum winding power *1 (Kg)			28			
Normal winding speed (with 1kg load) *2(m/min)			155			
AFS standard winding power *3(Kg)			10			
JAFS standard winding speed *3(m/min)			195			
Current (A)	No load		3			
	Stall		5			
	Max		15			
Speed shifting	No load		0 – 195 m / min (continuous shifting)			
Compatible battery			DAIWA Super Lithium Series DAIWA Tough Battery Series			

*1:Maximum winding power: Reference value of shaft torque at supply voltage 13V (Kg=Kgf·cm)

*2:Normal winding speed: Average winding speed of 100 m line with 1kg load at supply voltage 13V

*3:JAFS standard winding speed / winding speed = Regulation of JFTMA (Japan Fishing Tackle Manufacturer's Association), actual measurement value at supply voltage 13V

*The line winding capacity is listed for your reference only and it depends on the manufacturer, the item, and the tension.

Counter display

Depth display range	Upper counter: 0.0 to 3,000 m Lower counter: - 3,000 m to 3,000 m
Usable temp. range	-10 to +60 (degrees centigrade)

*The specifications are subject to change without prior notice for product improvement.

Parts List

SEABORG 200J/JL/J-DH/JL-DH

※The figure shows 200J

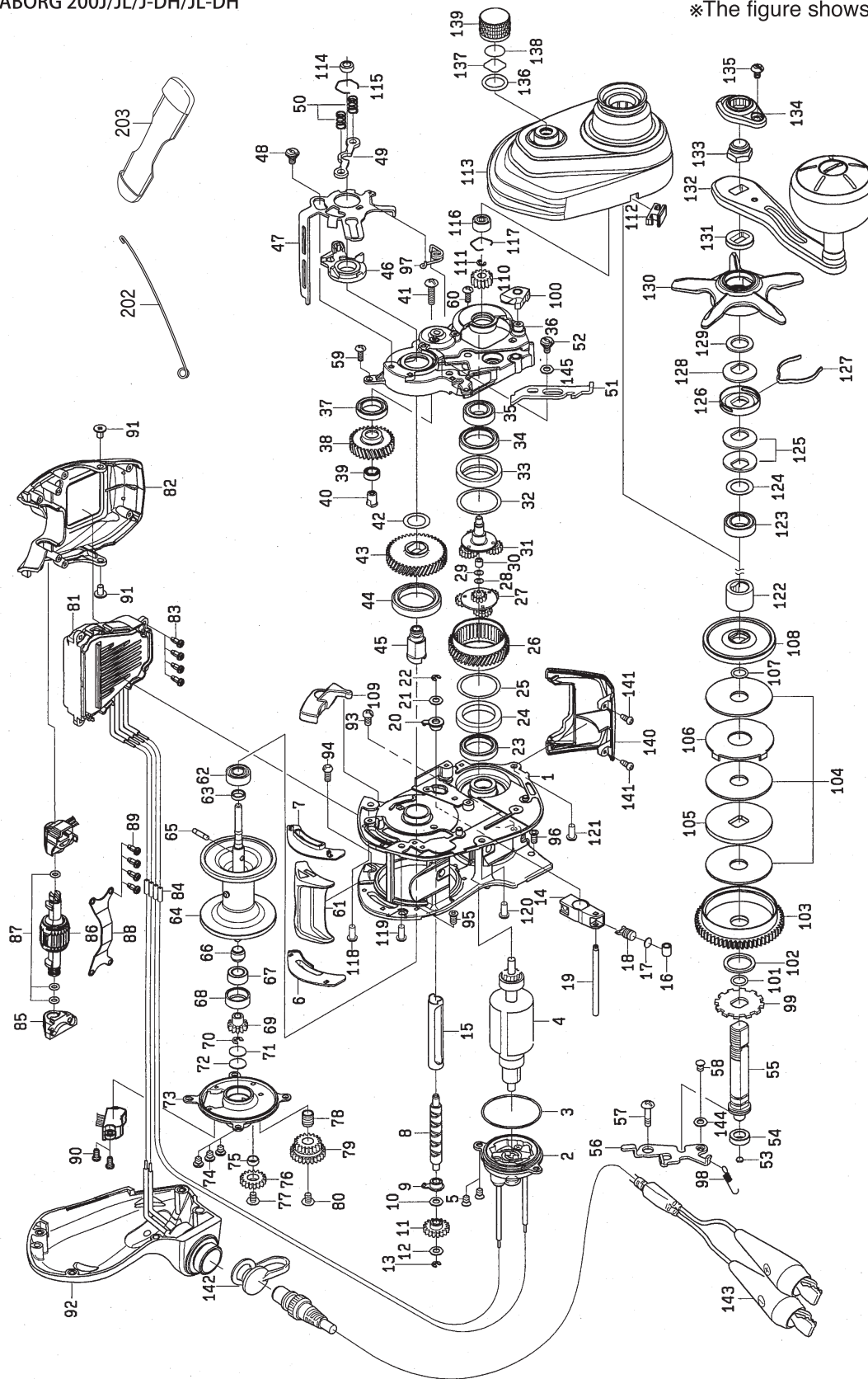

Parts List

SEABORG 200J/JL/J-DH/JL-DH

No.	Parts Name		No.	Parts Name	
	200J/J-DH	200JL/JL-DH		200J/J-DH	200JL/JL-DH
1	FRAME	FRAME	76	SET PLATE GEAR (C)	SET PLATE GEAR (C)
2	MOTOR HOLDER	MOTOR HOLDER	77	SET PLATE GEAR (C) SCREW	SET PLATE GEAR (C) SCREW
3	MOTOR HOLDER O-RING	MOTOR HOLDER O-RING	78	SET PLATE GEAR (D) COLLAR	SET PLATE GEAR (D) COLLAR
4	MOTOR	MOTOR	79	SET PLATE GEAR (D)	SET PLATE GEAR (D)
5	MOTOR HOLDER SCREW	MOTOR HOLDER SCREW	80	SET PLATE GEAR (D) SCREW	SET PLATE GEAR (D) SCREW
6	CLUTCH PLATE (L)	CLUTCH PLATE (R)	81	IC MODULE	IC MODULE
7	CLUTCH PLATE (R)	CLUTCH PLATE (L)	82	IC MODULE COVER	IC MODULE COVER
8	WORM SHAFT	WORM SHAFT	83	IC MODULE SCREW	IC MODULE SCREW
9	WORM SHAFT COLLAR(A)	WORM SHAFT COLLAR(A)	84	CORD COVER	CORD COVER
10	WORM SHAFT WASHER(A)	WORM SHAFT WASHER(A)	85	JOG POWER LEVER HOLDER	JOG POWER LEVER HOLDER
11	WORM SHAFT GEAR	WORM SHAFT GEAR	86	JOG POWER LEVER	JOG POWER LEVER
12	WORM SHAFT WASHER(B)	WORM SHAFT WASHER(B)	87	JOG POWER LEVER O RING	JOG POWER LEVER O RING
13	WORM SHAFT RETAINER(A)	WORM SHAFT RETAINER(A)	88	JOG POWER LEVER PLATE	JOG POWER LEVER PLATE
14	LEVEL WIND	LEVEL WIND	89	COVER PLATE SCREW	COVER PLATE SCREW
15	WORM SHIELD	WORM SHIELD	90	SENSOR SCREW	SENSOR SCREW
16	LEVEL WIND POST COLLAR	LEVEL WIND POST COLLAR	91	IC MODULE COVER SCREW	IC MODULE COVER SCREW
17	PAWL WASHER	PAWL WASHER	92	LS PLATE	RS PLATE
18	PAWL	PAWL	93	LS PLATE SCREW(A)	RS PLATE SCREW(A)
19	LEVEL WIND POST	LEVEL WIND POST	94	LS PLATE SCREW(B)	RS PLATE SCREW(B)
20	WORM SHAFT COLLAR(B)	WORM SHAFT COLLAR(B)	95	LS PLATE SCREW(C)	RS PLATE SCREW(C)
21	WORM SHAFT WASHER(C)	WORM SHAFT WASHER(C)	96	LS PLATE SCREW(D)	RS PLATE SCREW(D)
22	WORM SHAFT RETAINER(B)	WORM SHAFT RETAINER(B)	97	CLUTCH CAM SPRING	CLUTCH CAM SPRING
23	MOTOR HOUSE BALL BEARING(A)	MOTOR HOUSE BALL BEARING(A)	98	KICK LEVER SPRING	KICK LEVER SPRING
24	MOTOR HOUSE COLLAR(A)	MOTOR HOUSE COLLAR(A)	99	RATCHET	RATCHET
25	MOTOR HOUSE BEARING WASHER(A)	MOTOR HOUSE BEARING WASHER(A)	100	STOPPER	STOPPER
26	MOTOR HOUSE GEAR	MOTOR HOUSE GEAR	101	GEAR SHAFT O-RING	GEAR SHAFT O-RING
27	MOTOR GEAR (A)	MOTOR GEAR (A)	102	DRIVE GEAR WASHER	DRIVE GEAR WASHER
28	MOTOR GEAR (A) WASHER/ 0.3	MOTOR GEAR (A) WASHER/ 0.3	103	DRIVE GEAR	DRIVE GEAR
29	MOTOR GEAR (A) WASHER/ 0.1	MOTOR GEAR (A) WASHER/ 0.1	104	DRAG WASHER	DRAG WASHER
30	MOTOR GEAR (B) COLLAR	MOTOR GEAR (B) COLLAR	105	DRAG DISK WASHER	DRAG DISK WASHER
31	MOTOR GEAR (B)	MOTOR GEAR (B)	106	DRAG LIP WASHER	DRAG LIP WASHER
32	MOTOR HOUSE BEARING WASHER(B)	MOTOR HOUSE BEARING WASHER(B)	107	DRAG DISK COLLAR O-RING	DRAG DISK COLLAR O-RING
33	MOTOR HOUSE COLLAR(B)	MOTOR HOUSE COLLAR(B)	108	DRAG DISK COLLAR	DRAG DISK COLLAR
34	MOTOR HOUSE BALL BEARING(B)	MOTOR HOUSE BALL BEARING(B)	109	CLUTCH LEVER (B)	CLUTCH LEVER (B)
35	MOTOR GEAR (B) BALL BEARING	MOTOR GEAR (B) BALL BEARING	110	MOTOR GEAR (C)	MOTOR GEAR (C)
36	RS SET PLATE	LS SET PLATE	111	PINION RETAINER	PINION RETAINER
37	RS SET PLATE BALL BEARING	LS SET PLATE BALL BEARING	112	LINE STOPPER	LINE STOPPER
38	SET PLATE GEAR (A)	SET PLATE GEAR (A)	113	RS PLATE	LS PLATE
39	SET PLATE GEAR (A) BALL BEARING	SET PLATE GEAR (A) BALL BEARING	114	SET PLATE GEAR (B) SHAFT COLLAR	SET PLATE GEAR (B) SHAFT COLLAR
40	SET PLATE GEAR (A) COLLAR	SET PLATE GEAR (A) COLLAR	115	SET PLATE GEAR (B) SHAFT RING	SET PLATE GEAR (B) SHAFT RING
41	SET PLATE GEAR (A) SCREW	SET PLATE GEAR (A) SCREW	116	RS BEARING	LS BEARING
42	SET PLATE GEAR (B) WASHER	SET PLATE GEAR (B) WASHER	117	RS BEARING RING	LS BEARING RING
43	SET PLATE GEAR (B)	SET PLATE GEAR (B)	118	RS PLATE SCREW(A)	LS PLATE SCREW(A)
44	SET PLATE GEAR (B) BALL BEARING	SET PLATE GEAR (B) BALL BEARING	119	RS PLATE SCREW(B)	LS PLATE SCREW(B)
45	SET PLATE GEAR (B) SHAFT	SET PLATE GEAR (B) SHAFT	120	RS PLATE SCREW(C)	LS PLATE SCREW(C)
46	CLUTCH CAM	CLUTCH CAM	121	RS PLATE SCREW(D)	LS PLATE SCREW(D)
47	CLUTCH CAM PLATE	CLUTCH CAM PLATE	122	DRAG COLLAR	DRAG COLLAR
48	CLUTCH CAM PLATE SCREW	CLUTCH CAM PLATE SCREW	123	HANDLE BALL BEARING	HANDLE BALL BEARING
49	CLUTCH PLATE	CLUTCH PLATE	124	DRAG COLLAR WASHER	DRAG COLLAR WASHER
50	CLUTCH SPRING	CLUTCH SPRING	125	DRAG SPRING WASHER(A)	DRAG SPRING WASHER(A)
51	KICK LEVER	KICK LEVER	126	DRAG HOLDER	DRAG HOLDER
52	KICK LEVER SCREW	KICK LEVER SCREW	127	DRAG HOLDER LEAF SPRING	DRAG HOLDER LEAF SPRING
53	GEAR SHAFT WASHER	GEAR SHAFT WASHER	128	DRAG SPRING WASHER(B)	DRAG SPRING WASHER(B)
54	GEAR SHAFT COLLAR	GEAR SHAFT COLLAR	129	STAR DRAG WASHER	STAR DRAG WASHER
55	GEAR SHAFT	GEAR SHAFT	130	STAR DRAG	STAR DRAG
56	GEAR SHAFT PLATE	GEAR SHAFT PLATE	131	HANDLE COLLAR	HANDLE COLLAR
57	GEAR SHAFT PLATE SCREW (A)	GEAR SHAFT PLATE SCREW (A)	132	HANDLE ASSY	HANDLE ASSY
58	GEAR SHAFT PLATE SCREW (B)	GEAR SHAFT PLATE SCREW (B)	133	HANDLE NUT	HANDLE NUT
59	RS SET PLATE SCREW(A)	LS SET PLATE SCREW(A)	134	HANDLE ROCK PLATE	HANDLE ROCK PLATE
60	RS SET PLATE SCREW(B)	LS SET PLATE SCREW(B)	135	HANDLE ROCK PLATE SCREW	HANDLE ROCK PLATE SCREW
61	CLUTCH LEVER (A)	CLUTCH LEVER (A)	136	MECHANICAL BRAKE KNOB O-RING	MECHANICAL BRAKE KNOB O-RING
62	SPOOL BALL BEARING	SPOOL BALL BEARING	137	MECHANICAL BRAKE KNOB WASHER (A)	MECHANICAL BRAKE KNOB WASHER (A)
63	SPOOL BEARING COLLAR	SPOOL BEARING COLLAR	138	MECHANICAL BRAKE KNOB WASHER (B)	MECHANICAL BRAKE KNOB WASHER (B)
64	SPOOL	SPOOL	139	MECHANICAL BRAKE KNOB	MECHANICAL BRAKE KNOB
65	SPOOL PIN	SPOOL PIN	140	FINGER COVER	FINGER COVER
66	SPOOL GEAR BEARING COLLAR	SPOOL GEAR BEARING COLLAR	141	FINGER COVER SCREW	FINGER COVER SCREW
67	SPOOL GEAR BALL BEARING	SPOOL GEAR BALL BEARING	142	CONNECTOR CAP	CONNECTOR CAP
68	SPOOL GEAR COLLAR	SPOOL GEAR COLLAR	143	CORD	CORD
69	SPOOL GEAR	SPOOL GEAR	144	GEAR SHAFT PLATE WASHER	GEAR SHAFT PLATE WASHER
70	SPOOL GEAR RETAINER	SPOOL GEAR RETAINER	145	KICK LEVER WASHER	KICK LEVER WASHER
71	SPOOL WASHER (A)/0.2	SPOOL WASHER (A)/0.2	200	MANUAL (sold separately)	MANUAL (sold separately)
72	SPOOL WASHER (B)/0.5	SPOOL WASHER (B)/0.5	201	DRIVER	DRIVER
73	LS SET PLATE	RS SET PLATE	202	LINE THROUGH PIN	LINE THROUGH PIN
74	LS SET PLATE SCREW	RS SET PLATE SCREW	203	STAND COVER	STAND COVER
75	SET PLATE GEAR (C) COLLAR	SET PLATE GEAR (C) COLLAR	204	LOWER WINDING GAUGE	LOWER WINDING GAUGE

*There may sometimes be a difference between the purchased reel and the Dismantled Parts Chart or the parts list above due to the adjustment process etc. We appreciate your understanding.

Trouble shooting

Symptom	Possible causes	To do	Ref. page
Motor does not respond to the power lever.	The counter displays 2.0 m.	It is a normal function to avoid over winding.	P30
	Did not pull the lever to OFF position.	Pull the lever to OFF and then move forward again to start winding.	P13
	Unstable power source.	Use another power source, such as electric reel specific batteries.	P9
	The clutch has been turned OFF.	Turn ON the clutch to restart winding-up.	P33
Counter display does not appear.	Battery charge is low.	Recharge the battery.	P9
	Cord worn or corroded.	Replace the cord.	P11
	Incorrect battery connection.	Connect clips correctly without + / - reverse connection.	P8
Auto stop function does not work.	Did not press RESET BUTTON at surface.	Set the surface depth to zero after setting rig.	P30
	Error for sinker weight or rocking of the boat.	Adjust settings of auto stop function.	P31
	Line is elongated.	Reset the depth counter at the surface.	P30
There are counter errors.	Line length has increased due to stretching.	Re-enter line data.	P17~26
		Recalibrate the water depth.	P42
	Line was wound while powered off during fishing.	Re-enter line data.	P17~26
	RESET BUTTON was pressed and held while feeding the line.	Re-enter line data.	
Pickup does not respond.	Speed has been set to "0" (zero).	Go to the Menu screen to set the Jigging again.	P34
	Distance is already below +3 m from auto stop.	Designed not to wind in this range for safety.	P34
Jigging function does not respond.	Power lever is at OFF.	Set the jigging speed with the Jog Power Lever.	P35~37
	Distance is already below +3 m from auto stop.	Designed not to wind in this range for safety.	
	Pickup mode is selected.	Go to the Menu screen to set the Jigging.	

*Contact your dealer if the reel does not function properly despite the above details being confirmed, in the event of other problems arising, and to order parts.

アフターサービスについて

本製品は当社の厳重な検査を経て出荷されたものですが、万一、故障が生じ修理が必要な場合、あるいは部品御注文の際は買い求めの販売店、または下記のお客様センターまでお問い合わせください。なお、修理品は部品代のほか手数料をいただきますのでご了承ください。

お客様センター（無料） 携帯電話からでもご利用できます

TEL **0120-506-204**

受付時間：9:00～17:00 （土・日・祝祭日は除く）

ホームページ上からでも確認、お問い合わせできます

www.daiwa.com/jp/

グローブライド株式会社

〒203-8511 東京都東久留米市前沢3-14-16